



GENERAL CATALOG

WORKSHOP SECTOR

2015 - ENG

since 1967
www.smeclean.com

rev. 1.0

L'azienda

On the market for more than 40 years, the company SME was established in 1967 by Mario Caroli in Ozzano dell'Emilia (Bologna, Italy). Its craftmade production was mainly consisting of washing systems for Olivetti typewriters.

Soon after the first parts washers were built for mechanical parts cleaning in the maintenance sector of cars, trucks and tractors. In the late 70's Aurelio Caroli becomes the new manager, giving a dynamic impulse to the company.

SME s.r.l. was established in 1987 and, inheriting all the experience gained over the years, it continues its positive growth trend.

Till today the company has tried to invest in new technologies and research to ensure a continuous improvement of the product. Today SME is one of the most important European companies in the field of industrial washing.

Over the years SME has manufactured many and various parts washers, which in most cases replaced those systems using solvents, thus obtaining the satisfaction of customers from different market sectors.

The choice to use water and biodegradable detergents instead of solvents proved to be fundamental, especially in recent years, following to the explosion of ecological problems and the ever existing need to replace the solvents with less dangerous products.

1970



1980



1985



1995



Quality

SME systems have always been considered synonymous of quality and reliability. Over the years SME has studied how the various types of washing jet influence the quality of the washing process. The best choice adopted by SME is certainly to use the "pin" jet: it is called in this way because the water jet comes out of the nozzle shaped as a pin, differently from the blade or "fan" jet.

The most obvious defects of the washing system with blade nozzles are:

- ⊗ water pressure on the part to be washed is much lower than the maximum pump pressure
- ⊗ greater is the distance of the blade nozzle from the surface to be washed, lower is the impact strength, consequently minor is the ability to wash and remove dirt from the surfaces.
- ⊗ in the washing of cavities and blind holes, the fan jet does not penetrate into the hole or cavity but fills the blind holes with water without emptying them from the processing residues.

The advantages of the washing system with pin nozzles are:

- ⊗ the impact pressure on the surface to be washed equals the maximum pump pressure
- ⊗ in the washing of blind holes or cavities, the pin jet penetrates into the hole reaching the bottom and, as it comes out, it drags out the processing residues.
- ⊗ the distance between the nozzle and the surface to be washed does not influence the impact pressure.



The company production line is constantly monitored in order to correct any assembly mistakes. Moreover, each processing stage is followed by a monitoring and/or testing phase, thanks to which some production mistakes or defective parts are detected and fixed.

Each washing system is tested for at least 24 hours (of actual cycle). Sometimes, the testing procedure can last for weeks, depending on possible problems detected or on the complexity of the system.

Each washing system is associated with a serial number, thanks to which traceability can be ensured.

The label bearing the serial number, the machine consumption data, year of manufacture and other information, can be found on several points on the machine, as well as on the use and maintenance manual. Thanks to the serial number you are able to trace the whole history of the machine: the type of installed components, the electrical and hydraulic diagrams, the whole sales documentation.



Thanks to the serial number you are able to trace the whole history of the machine: the type of installed components, the electrical and hydraulic diagrams, the whole sales documentation.

Component checks both at the inlet and during assembly as well as component standardisation and encoding make the manufacturing process safer and less prone to mistakes or defects.

Customer service is fast, accurate, both by telephone and operationally, supported by internal procedures providing customers with a constant attention and professionalism.

Each washing system is delivered with the Use and Maintenance manual containing the EC declaration of conformity.

Safety

Industrial washing machines are subject to product standards. **In 2005 the harmonized product standards relating to industrial washing machines became operational. Until that moment, they were still in the planning stage.**

These rules, codified as EN 12921, have been prepared by the Technical Committee 271 of CEN, the body responsible for the development of harmonized standards at European level.

More precisely, they concern machines for surface cleaning and for the pre-treatment of industrial parts with liquids or vapours.

Currently there are four product standards: EN 12921-1, -2, -3, -4.

For some time SME srl has been designing and manufacturing its machines in accordance with the standards listed above, with the help of a studied and careful analysis of risks.

The following list contains some safety aspects concerning washing machines that are taken into consideration by the harmonized standards.

The basic product standard determines the measures to eliminate or reduce the risks due to high temperatures and SME has adapted to these requirements very quickly.

Therefore, measures have been taken to limit the temperature of the washing fluid, to reduce surface temperature by means of insulation or guards, to protect the operator from liquids or vapours, and, where the risk could not be avoided, by means of visual markings, as well as suitable documentation on the Use and Maintenance Manual.

To better meet these standards, the models are manufactured in two different types:

⊗ **LT model for washing temperatures up to 60°C.**

⊗ **HT model for washing temperatures up to 80°C.**

Vapour extraction is standard on all HT models and also on LT models with a total chamber volume greater than 0.7 m³.

Machines also have the EC marking of conformity to product-specific directives established by the European Union.



The materials and components used were chosen appropriately to withstand the environmental conditions of use of the system.

The components that may come into contact with the external environment have a protection degree not lower than IP 55.

The control circuit is supplied with 24V (230V for single phase models).

Some circuits have been designed and built according to the principle of redundancy.

The control system - DGT V4

Models: Simplex, Simplex Big.

The panel is made up of **SIEMENS** electromechanical components, the control circuit works at 24VDC.

The **PLC** installed on DGT V4 systems manages signal inputs and outputs and controls the activation of resistors and motors.

The color **TOUCH SCREEN** display shows all the informations of the machine and contains all the working commands.

The software installed allows you to:

- ✓ customize machine functions (time, temperatures, etc.)
- ✓ set the weekly programming for the activation of the washing liquid heating
- ✓ set the weekly programming for the activation of the oil separator (if installed)
- ✓ set the language for the information displayed
- ✓ manage the liquid minimum, maximum and safety temperatures
- ✓ manage reports and machine alarms
- ✓ have information on the machine total cycle time (hour counter, cycle counter)
- ✓ enable advanced features such as:
 - ✓ energy saving (to optimise the overall power consumption of the machine)
 - ✓ automatic start (to start the cycle as soon as the lid has been closed)
 - ✓ manage the ordinary maintenance timing

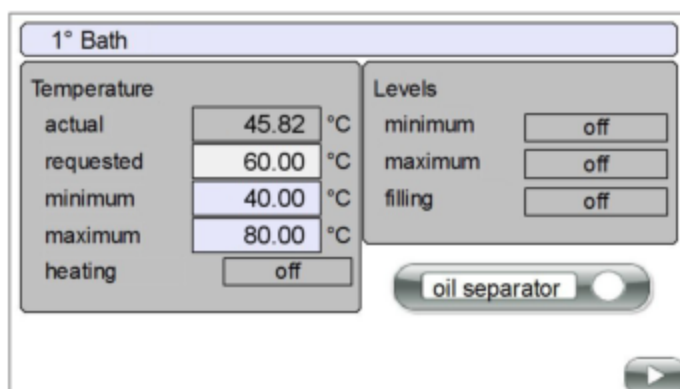
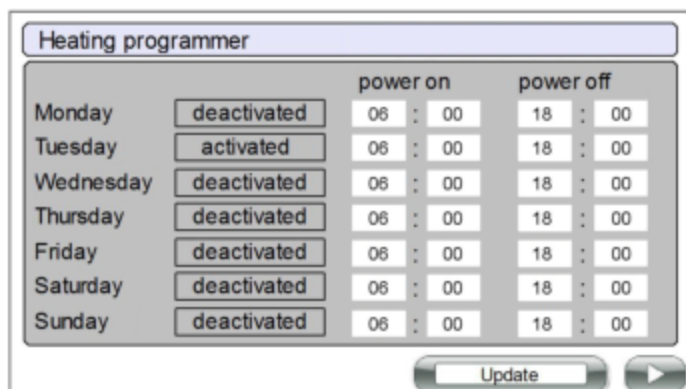
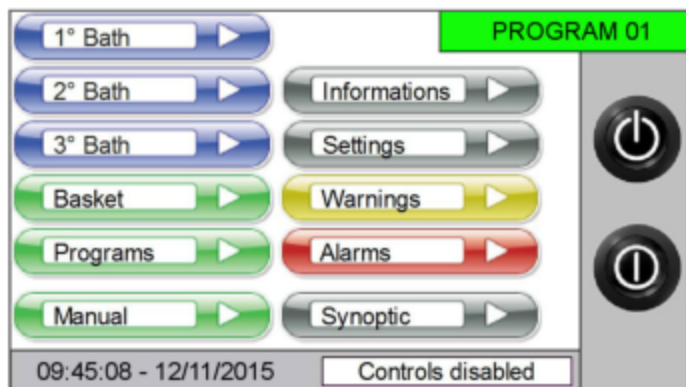

Minilav

Minilav is a compact and strong system for successfully washing of small parts and it has been designed to be placed in narrow areas or on workbenches.

Washing is carried out by using the upper and lower jets, whose rotation is ensured by the powerful stainless steel pump.

The operator can set the tank fluid temperature and the treatment time.

Model

- MINILAV, wash. cap. of 35 x 35 x H30 cm x 20kg

Version

- electric, maximum washing temperature: 60°C

Supply voltage

- 230V 1PH+T 50 HZ



STANDARD EQUIPMENT

- **Basket of reinforced PVC with border H15 cm**
- Minimum tank level check to protect pump and resistor
- Compact size, it is designed to be placed on worktables
- **Electric pump of stainless steel with special gaskets**
- Electrical resistor of Incoloy stainless steel
- Structure and sheets of stainless steel
- Rotating piping of stainless steel Aisi 304 with «laser» jets
- «Lantern» door closing system
- **Filter on pump suction (500 µ)**
- Safety microswitch on door opening

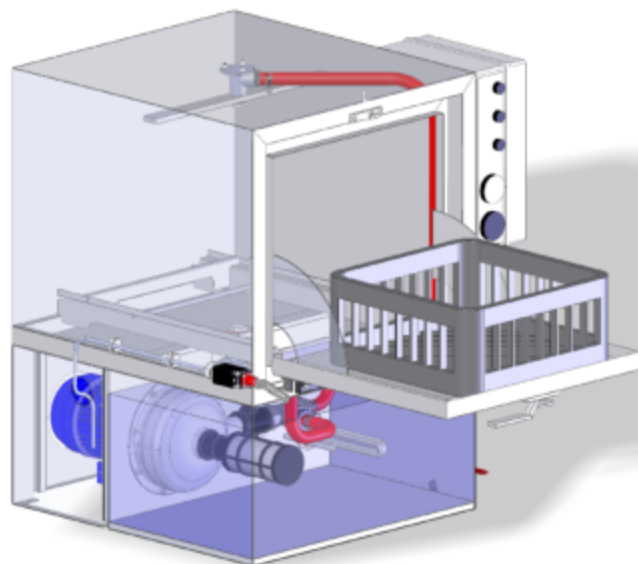

Technical table	MINILAV
Closed machine overall dim. (WxDxH)	70 x 62 x 78 cm
Opened machine overall dim. (WxDxH)	70 x 105 x 78 cm
Washing capacity (WxDxH)	35 x 35 x 30 cm
Basket load capacity	20 kg
Machine weight	50 kg
Tank capacity	30 lt
Washing pump	0,37 kw 2,0 bar 40 lt/min
Washing heating	2,0 kw
Power supply	230V 1PH+T

Connections	MINILAV
Drain washing tank	F 1/2" GAS

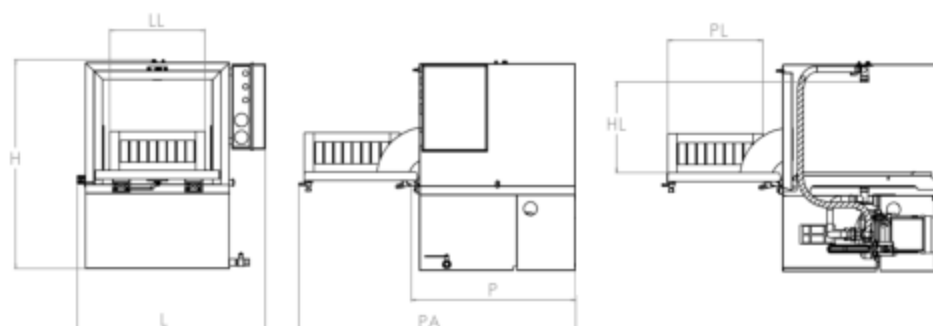

Table of dimensions	MINILAV
L (width)	70 cm
P (depth)	62 cm
H (height)	78 cm
LL (washing width)	35 cm
PL (washing depth)	35 cm
HL (washing height)	30 cm
PA (open depth)	105 cm
HA (opening angle)	90°

Lavapen

This system allows you to wash small and medium sized mechanical parts successfully. The treatment is performed manually by means of two gloves fitted on the front part.

The cleaning results are ensured by a high pressure pump and the special spray nozzle. The latter can be quickly replaced with the cleaning brush thanks to the quick attachments.

The machine is equipped with a compressed air gun for drying the parts and an extracting system for vapours produced inside the chamber.

Models

- LP2, washing capacity of 70 x 55 x H45 cm x 70kg
- LP3, washing capacity of 95 x 70 x H55 cm x 70kg
- LP4, washing capacity of 120 x 80 x H55 cm x 70kg

Versions

- pneumatic for solvents (P)
- electric, maximum washing temperature: 60°C (C)

Supply voltage

- compressed air (pneumatic version)
- 230V 1PH+T 50 HZ (electric version)



Technical table	LP 2	LP 3	LP 4
Closed machine overall dim.(WxDxH)	95 x 70 x 160 cm	120 x 85 x 170 cm	145 x 95 x 180 cm
Open machine overall dim.(WxDxH)	95 x 85 x 165 cm	120 x 100 x 175 cm	145 x 110 x 185 cm
Washing capacity (WxDxH)	70 x 55 x 45 cm	95 x 70 x 55 cm	120 x 80 x 55 cm
Load capacity	70 kg	70 kg	70 kg
Washing tank capacity	40 lt	75 lt	90 lt
Washing pump electric models	1,5 kw 9,0 bar 10 litre/min	1,5 kw 9,0 bar 10 litre/min	1,5 kw 9,0 bar 10 litre/min
Washing pump pneumatic models	5,0 bar 2 litre/min	5,0 bar 2 litre/min	5,0 bar 2 litre/min
Washing heating electric models	2,0 kw	2,0 kw	2,0 kw
Supply electric models	230V 1PH+T	230V 1PH+T	230V 1PH+T
Supply pneumatic models	comp. air 6 bar	comp. air 6 bar	comp. air 6 bar
Comp. air consump. electric models (except blowing)	10 litre/min 0,6 m³/h	10 litre/min 0,6 m³/h	10 litre/min 0,6 m³/h
Comp. air consump. pneumatic models (except blowing)	20 litre/min 1,2 m³/h	20 litre/min 1,2 m³/h	20 litre/min 1,2 m³/h

STANDARD EQUIPMENT

- Vapour extraction via Venturi compressed air system with throttle valve
- Interchangeable pressure washing nozzle and brush with quick attachment
- Compressed air blowing gun
- Removable panels of stainless steel Aisi 304 between the washing chamber and tank
- Closing door with hoses and integrated tempered glass
- Assisted door closing with gas spring and hook
- Filter on pump suction (500 µ)
- Washing activation by pedal
- Safety microswitch on door opening
- Plates of stainless steel

SPECIFIC EQUIPMENT IN ELECTRIC VERSION

- Electric pump
- External neon light for interior lighting
- Heating resistor of Incoloy Stainless Steel
- Minimum tank level control to protect pump and resistor
- Red gloves of PVC (oil and grease-repellent, good resistance to acidic products)

SPECIFIC EQUIPMENT IN PNEUMATIC VERSION

- Pneumatic diaphragm pump (max air consumption: 10 litre/min. at 6 bar)
- Green gloves of Ekatsu® (oil and grease-repellent, excellent resistance to acidic and basic products)

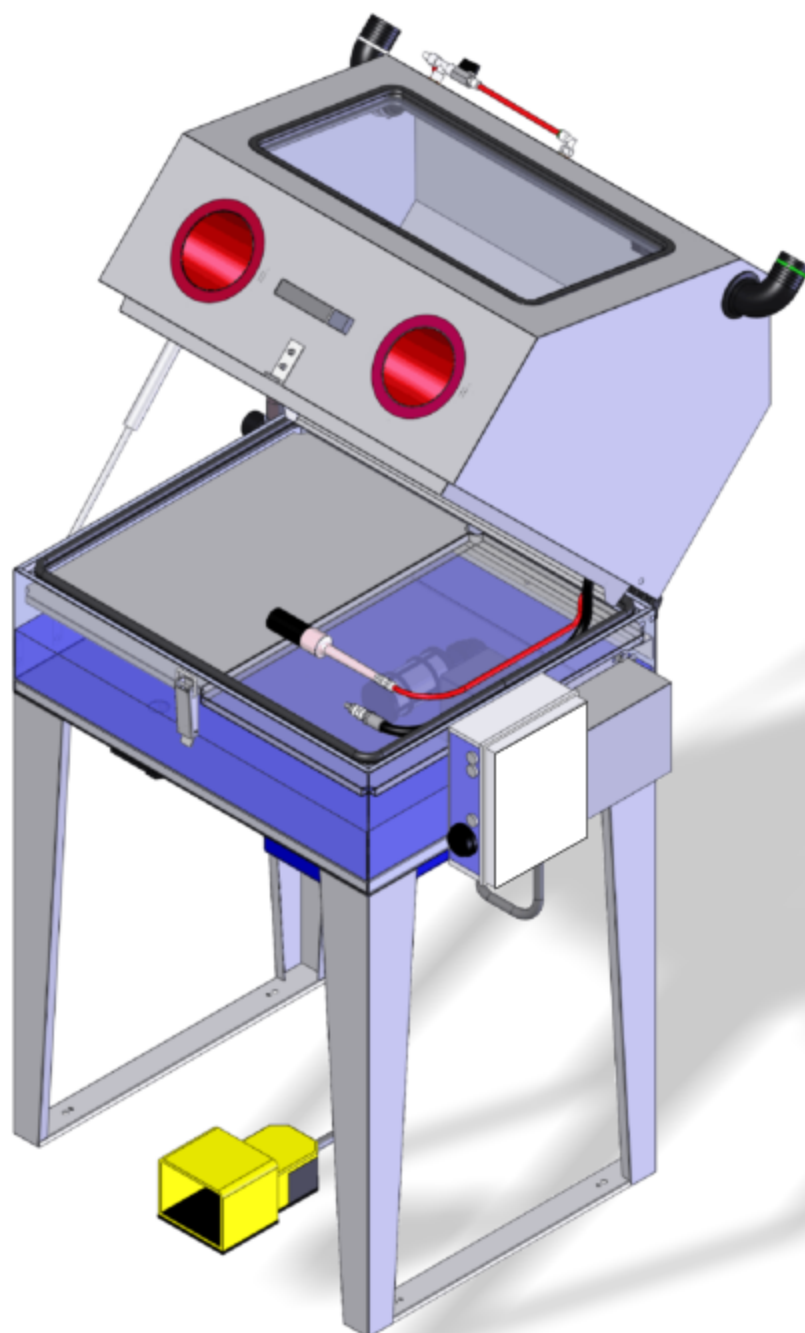
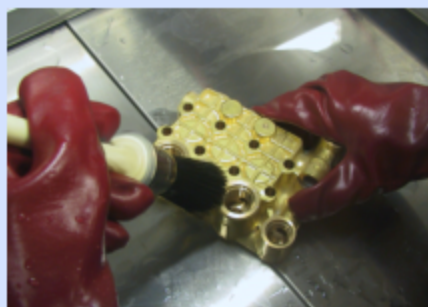

Connections	LP
Vapour extraction discharge	Ø 55 mm
Compressed air input	F 1/4" GAS
Drain washing tank	F 1" GAS

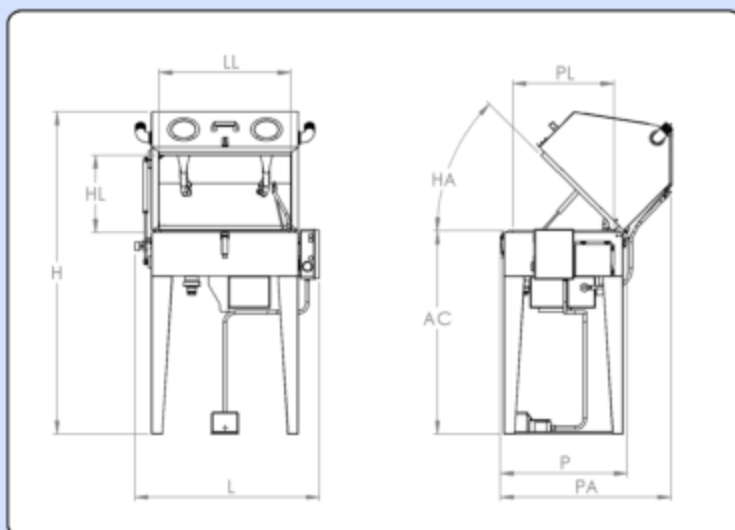

Table of dimensions	LP 2	LP 3	LP 4
L (width)	95 cm	120 cm	145 cm
P (depth)	70 cm	85 cm	95 cm
H (height)	165 cm	175 cm	185 cm
LL (washing width)	70 cm	95 cm	120 cm
PL (washing depth)	55 cm	70 cm	80 cm
HL (washing height)	45 cm	55 cm	55 cm
PA (open depth)	85 cm	100 cm	110 cm
AC (load height)	100 cm	100 cm	100 cm
HA (opening angle)	55°	55°	55°
ASP (vapour extraction)	Ø 55 mm	Ø 55 mm	Ø 55 mm

Lavapen AP50

This system allows you to wash small and medium sized mechanical parts successfully. The treatment is performed manually by means of two gloves fitted on the front part. The cleaning results are ensured by an **high pressure pump that can reach 80 bar** and the special spray nozzle. The machine is equipped with a compressed air gun for drying the parts and an extracting system for vapours produced inside the chamber.

Models

- LP3 AP50, wash. cap. 95 x 70 x H55 cm x 70kg
- LP4 AP50, wash. cap. 120 x 80 x H55 cm x 70kg

Versions

- electric, max. washing temperature: 60°C

Supply voltage

- 230V 1PH+T 50 HZ



Tabella tecnica	LP 3 AP 50	LP4 AP 50
Closed machine overall dim.(WxDxH)	120 x 85 x 170 cm	145 x 95 x 180 cm
Open machine overall dim.(WxDxH)	120 x 120 x 185 cm	145 x 110 x 185 cm
Washing capacity (WxDxH)	95 x 70 x 55 cm	120 x 80 x 55 cm
Load capacity	70 kg	70 kg
Washing tank capacity	75 lt	90 lt
Washing pump	1,87 kw 80,0 bar 15 lt/min	1,87 kw 80,0 bar 15 lt/min
Washing heating	2,0 kw	2,0 kw
Electrical supply	230V 1PH+T	230V 1PH+T
Comp. air consump. (except blowing)	10 lt/min 0,6 m³/h	10 lt/min 0,6 m³/h

STANDARD EQUIPMENT

- **Vapour extraction** via Venturi compressed air system with throttle valve
- **Pressure washing nozzle**
- **Compressed air blowing gun**
- Removable panels of stainless steel Aisi 304 between the washing chamber and tank
- Closing door with hoses and integrated tempered glass
- Assisted door closing with gas spring and hook
- **Double filter on pump suction** (500 µ)
- Washing activation by pedal
- Safety microswitch on door opening
- Plates of stainless steel
- **80 bar high pressure pump**
- **External neon light** for interior lighting
- Heating resistor of Incoloy Stainless Steel
- Minimum tank level control to protect pump and resistor
- High quality gloves of NEOPRENE L = 800mm
- Pump pressure adjustable from 1 to 80 bar
- Internal pressure gauge to check pump pressure
- Internal system to fix the washing nozzle in vertical position

AVAILABLE ACCESSORIES

① Washing gun instead of washing nozzle

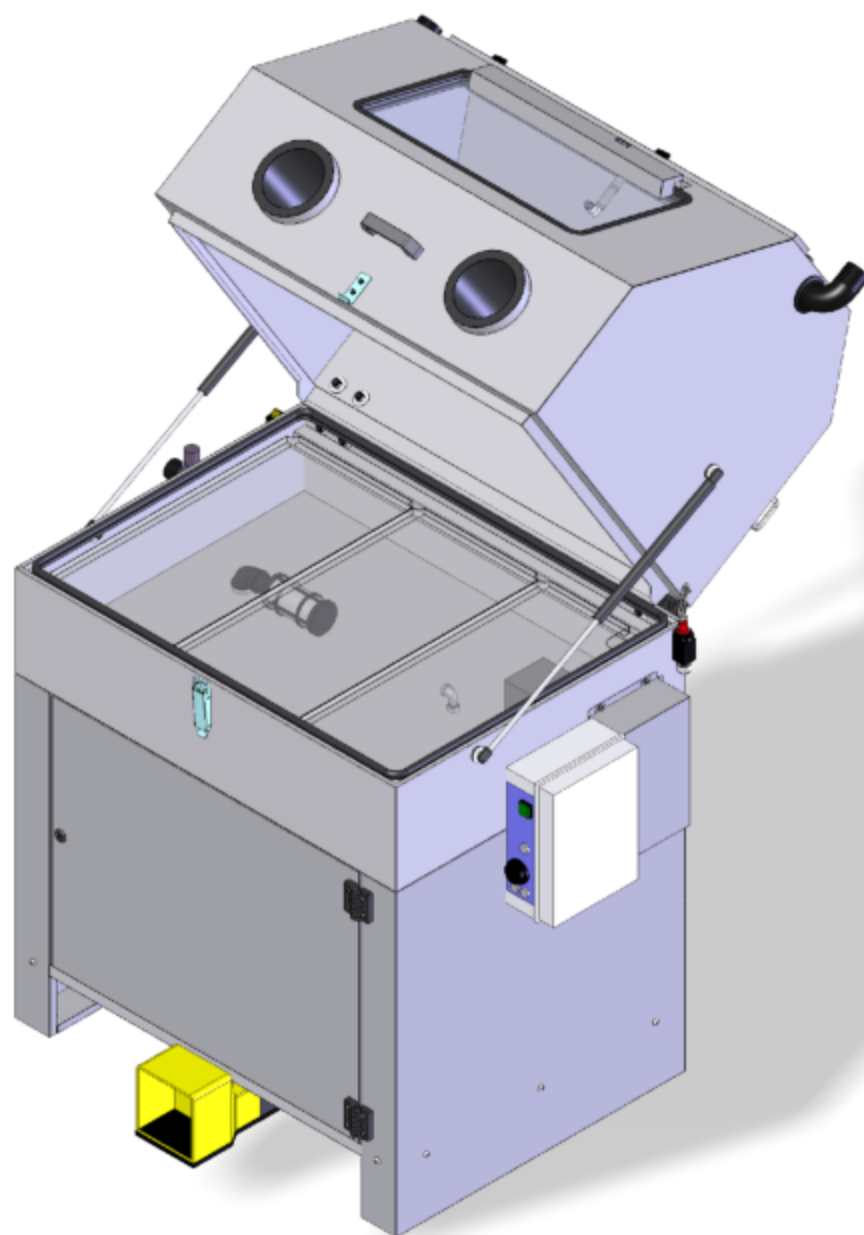

Connections

LP

Vapour extraction discharge	Ø 55 mm
Compressed air input	F 1/4" GAS
Drain washing tank	F 1" GAS

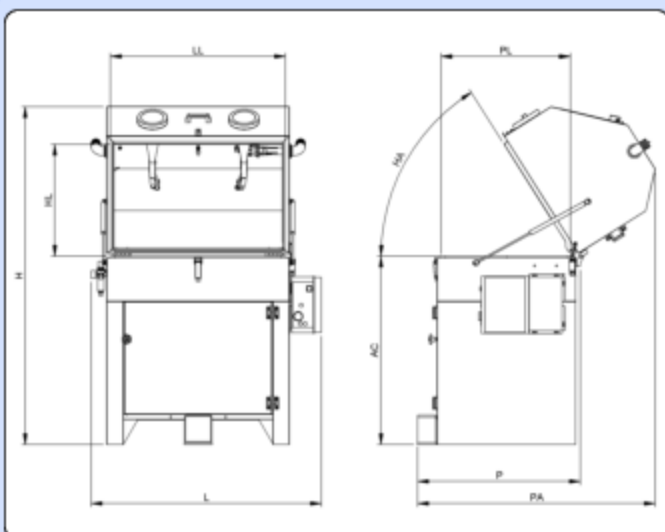

Table of dimensions

LP 3 AP 50

LP 4 AP 50

L (width)	120 cm	145 cm
P (depth)	85 cm	95 cm
H (height)	185 cm	185 cm
LL (washing width)	95 cm	120 cm
PL (washing depth)	70 cm	80 cm
HL (washing height)	55 cm	55 cm
PA (open depth)	120 cm	120 cm
AC (load height)	100 cm	100 cm
HA (opening angle)	58°	58°
ASP (vapour extraction)	Ø 55 mm	Ø 55 mm

P 60/80

P is a system that washes mechanical parts automatically. Washing is carried out by the upper, lower and side jets, the basket turn thanks to a gearmotor. Control panel is composed by electromechanic components. The operator can set the tank fluid temperature and the treatment time.

Models

- P 60, wash. cap. Ø58 x H38 cm x 100kg
- P 80, wash. cap. Ø78 x H43 cm x 100kg

Version

- electrical LT, max. washing temperature: 60°C

Supply voltage

- 400V 3PH+T 50 HZ (others on request)



STANDARD EQUIPMENT

- Electromechanical control panel
- Mechanical basket rotation with gearmotor
- **Reinforced basket** of electrowelded net with external edge of galvanised steel
- Minimum tank level control to protect pump and resistor
- **Electric pump of stainless steel with special gaskets**
- **Filter of stainless steel Aisi 304 on pump suction**
- **Tub edge gasket**
- Electrical box of painted metal
- Safety limit switch on cover opening
- Structure and sheets of stainless steel
- Fluid heating with electrical resistor of Incoloy stainless steel
- **Laser-drilled washing piping of Stainless steel (more pressure, less maintenance)**
- **Flexible suction and delivery pump pipes (easy maintenance)**

AVAILABLE ACCESSORIES

- ① Disc oil separator integrated to mechanical rotation
- ② Panels under the basket with grease collecting filters
- ③ Stainless steel Aisi 304 basket

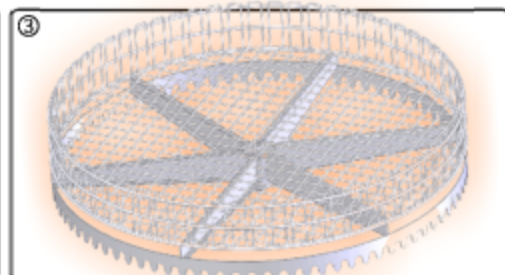
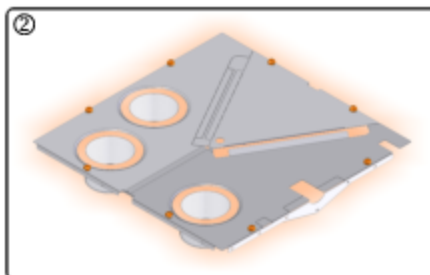
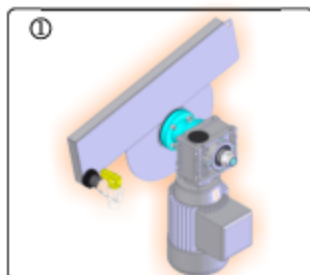

Technical table	P 60	P 80
Closed machine overall dimensions (W x D x H)	92 x 78 x 100 cm	112 x 100 x 110 cm
Open machine overall dimensions (W x D x H)	92 x 86 x 153 cm	112 x 105 x 185 cm
Washing capacity (Ø x H)	58 x 38 cm	78 x 43 cm
Basket load capacity	100 kg	100 kg
Washing tank capacity	60 lt	130 lt
Washing pump	0,55 kw 2,0 bar 80 lt/min	0,55 kw 2,0 bar 80 lt/min
Washing heating elements	4,0 kw	4,0 kw
Mechanical rotation	0,09 kw	0,09 kw
Disc oil separator	0,09 kw	0,09 kw
Steams extraction	-	-
Electrical supply	3PH+T	3PH+T

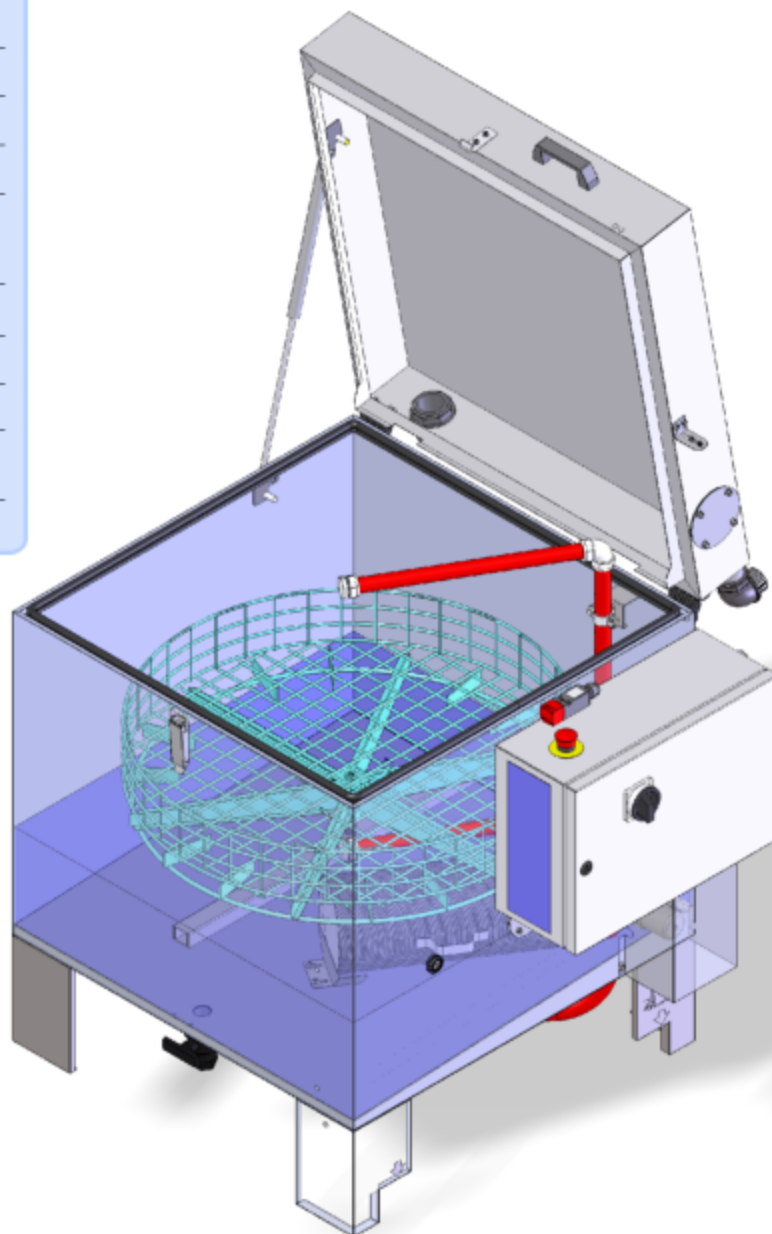

Connections	P 60 / 80
Drain washing tank	F 1" GAS
Drain disk oil separator	M 1/2" GAS
Vapour extraction outlet	-

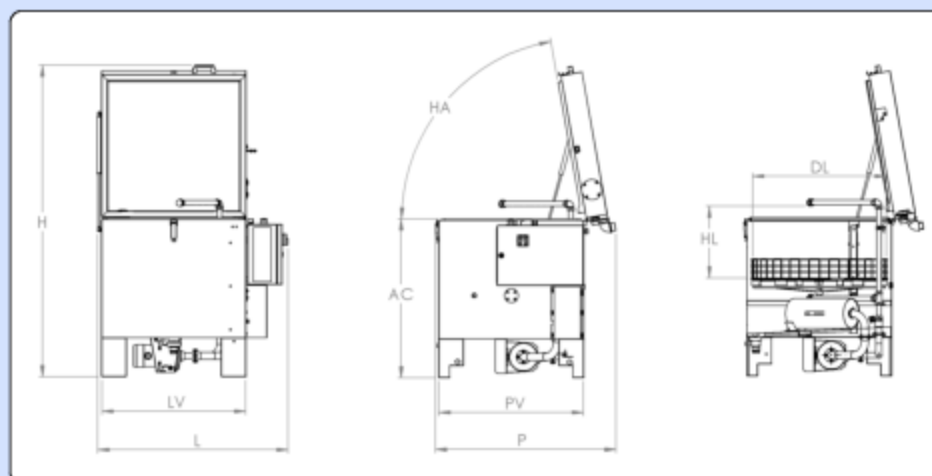

Table of dimensions	P 60	P 80
L (width)	92 cm	112 cm
P (depth)	86 cm	105 cm
H (height)	153 cm	185 cm
DL (washing diameter)	58 cm	78 cm
HL (washing height)	38 cm	43 cm
AC (load height)	83 cm	92 cm
LV (tank width)	64 cm	84 cm
PV (tank depth)	64 cm	84 cm
HA (opening angle)	80°	80°

P 100/120

P is a system that washes mechanical parts automatically.

Washing is carried out by the upper, lower and side jets, the basket turn thanks to a gearmotor. Control panel is composed by electromechanic components. The operator can set the tank fluid temperature and the treatment time.

Models

- P 100, wash. cap. Ø97 x H54 cm x 200kg
- P 120, wash. cap. Ø117 x H70 cm x 300kg

Version

- electrical LT, max. washing temperature 60°C

Supply voltage

- 400V 3PH+T 50 HZ (others on request)



STANDARD EQUIPMENT

- Electromechanical control panel
- Mechanical basket rotation with gearmotor
- **Electrical vapour extraction**
- **Reinforced basket** of electrowelded net with external edge of galvanised steel
- Minimum tank level control to protect pump and resistor
- **Electric pump of stainless steel with special gaskets**
- **Filter of stainless steel Aisi 304 on pump suction**
- **Tub edge gasket**
- Electrical box of painted metal
- Safety limit switch on cover opening
- Structure and sheets of stainless steel
- Fluid heating with electrical resistor of Incoloy stainless steel
- **Laser-drilled washing piping of Stainless steel (more pressure, less maintenance)**
- **Flexible suction and delivery pump pipes (easy maintenance)**

AVAILABLE ACCESSORIES

- ① Disc oil separator with dedicated gear motor
- ② Panels under the basket with grease collecting filters
- ③ Stainless steel Aisi 304 basket

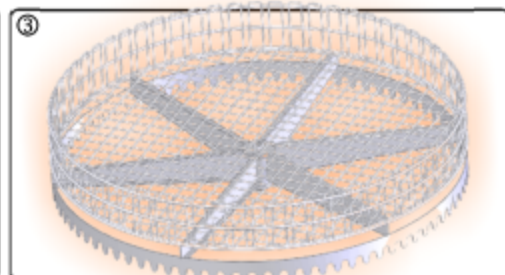
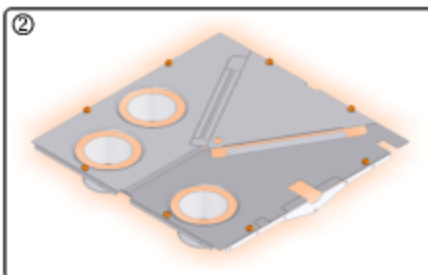
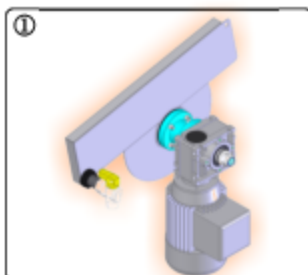

Technical table	P 100	P 120
Closed machine overall dimensions (W x D x H)	146 x 144 x 125 cm	166 x 159 x 145 cm
Open machine overall dimensions (W x D x H)	146 x 175 x 191 cm	166 x 206 x 211 cm
Washing capacity (Ø x H)	97 x 54 cm	117 x 70 cm
Basket load capacity	200 kg	300 kg
Washing tank capacity	210 lt	270 lt
Washing pump	1,5 kw 2,5 bar 200 lt/min	1,5 kw 2,5 bar 200 lt/min
Washing heating elements	6,0 kw	8,0 kw
Mechanical rotation	0,09 kw	0,09 kw
Disc oil separator	0,09 kw	0,09 kw
Steams extraction	0,25 kw 320 m³/h	0,25 kw 320 m³/h
Electrical supply	3PH+T	3PH+T

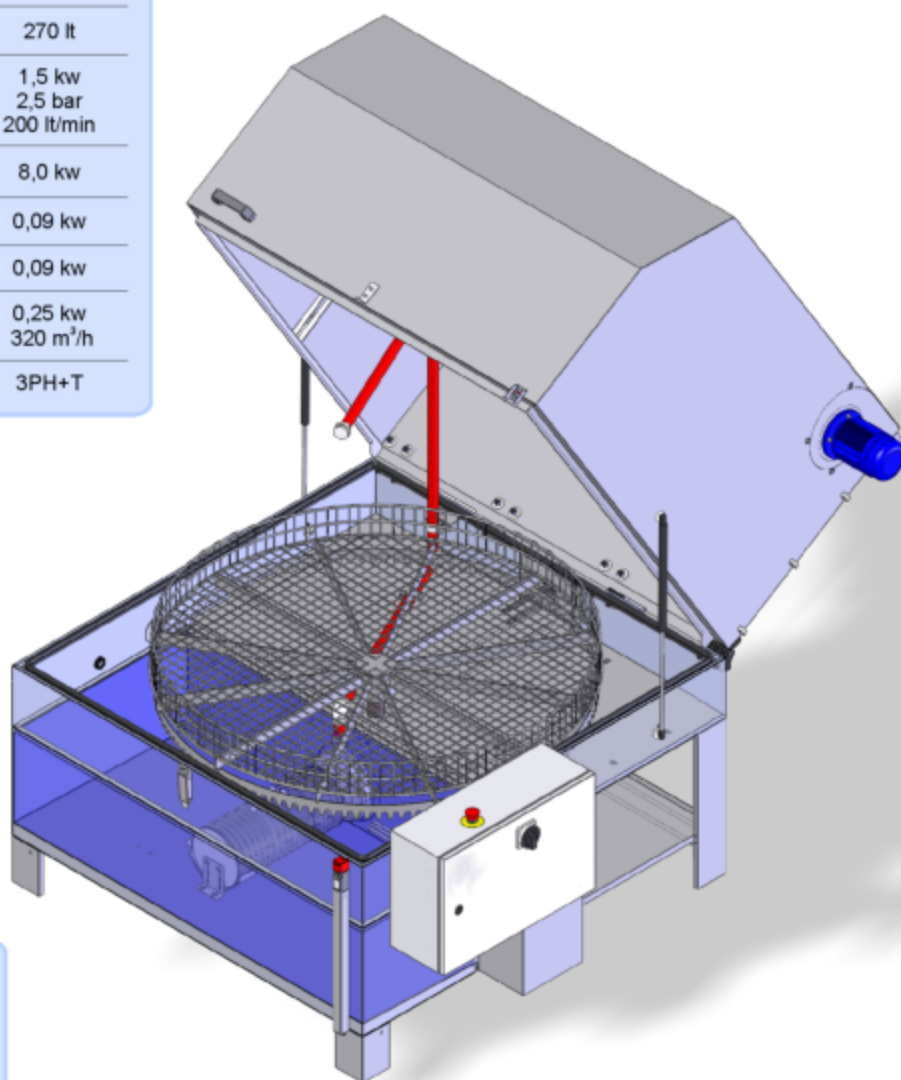

Connections	P 100 / P 120
Drain washing tank	F 1" GAS
Drain disk oil separator	M 1/2" GAS
Vapour extraction outlet	Ø 80 mm

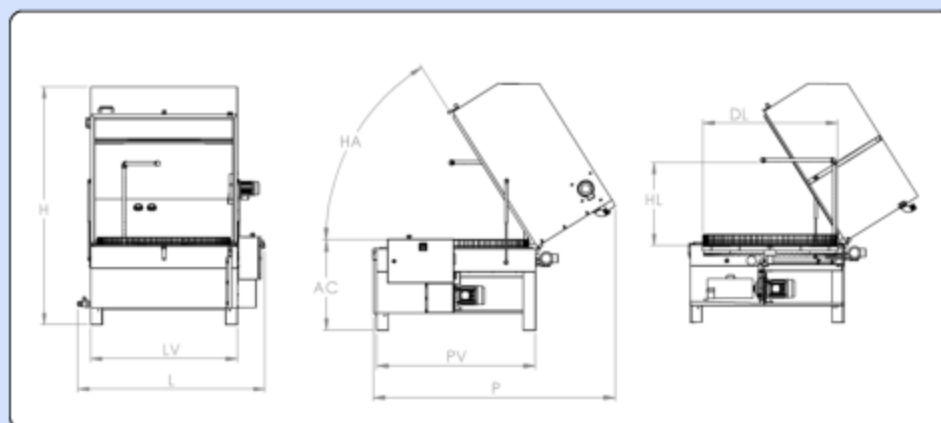

Table of dimensions	P 100	P 120
L (width)	146 cm	166 cm
P (depth)	175 cm	206 cm
H (height)	191 cm	211 cm
DL (washing diameter)	97 cm	117 cm
HL (washing height)	54 cm	70 cm
AC (load height)	67 cm	67 cm
LV (tank width)	110 cm	130 cm
PV (tank depth)	120 cm	135 cm
HA (opening angle)	60°	60°

Atom

Atom is a system that washes automatically medium and large mechanical parts. Washing is carried out by using the upper and lower jets, whose rotation is ensured by the powerful steel pump. Control panel is composed by electromechanic components. The operator can set the tank fluid temperature and the treatment time.

Models

- Atom 1000, was. cap. of Ø90 x H70 cm x 600kg
- Atom 1200, was. cap. of Ø110 x H80 cm x 600kg
- Atom 1400, was. cap. of Ø128 x H90 cm x 600kg
- Atom 1800, was. cap. of Ø165 x H100 cm x 600kg
- Atom 2200, was. cap. of Ø200 x H100 cm x 600kg

Versions

- electric LT, max. washing temperature: 60°C
- electric HT, max. washing temperature: 80°C

Supply voltage

- 400V 3PH+N+T 50HZ (others on request)



STANDARD EQUIPMENT

- **Timed vapour extraction**
- **Two-hand control for door closing with safety control unit**
- External loading/unloading area with drip collector of stainless steel Aisi 304
- ISO pneumatic cylinders and «anti-fall» pneumatic safety valves
- **Electric pump of cast iron with special gaskets**
- Filter of stainless steel Aisi 304 on pump suction
- Minimum level control of the liquid inside the tank to protect pump and resistor
- Maximum level control of the liquid inside the tank and solenoid valve for automatic water filling
- **Double series of upper, side and lower rotating washing pipes, laser-drilled of stainless steel**
- Electrical resistors of Incoloy stainless steel
- Safety limit switch on door opening
- **Electrical cabinet Ip65, electromechanical control panel**
- Structure and sheets of stainless steel
- Lower load-bearing structure of galvanized iron
- **Triple door gasket (lower, upper and lateral)**
- Reinforced platform of pressed grating with raised external edge, of galvanised iron
- Sludge discharging door for an easy tank cleaning

SPECIFIC EQUIPMENT FOR HT VERSION

- Overall thermal insulation with panels of stainless steel Aisi 430

AVAILABLE ACCESSORIES

- ① Platform borders, removable, H20 cm, of stainless steel Aisi 304
- ② Disc oil separator with gearmotor
- ③ Panels under the platform with grease collecting filters
- ④ Emptying pump
- ⑤ High pressure washing pump
- ⑥ Platform of stainless steel Aisi 304
- ⑦ Detergent dosage system
- ⑧ System retention tank of stainless steel Aisi 304
- ⑨ External pneumatic oil separator
- ⑩ Liquid heating by diesel or natural gas burner
- ⑪ Predisposition for the use with abrasive contaminants
- ⑫ Predisposition for the use with strongly caustic chemical products
- ⑬ Bleaching of internal welding

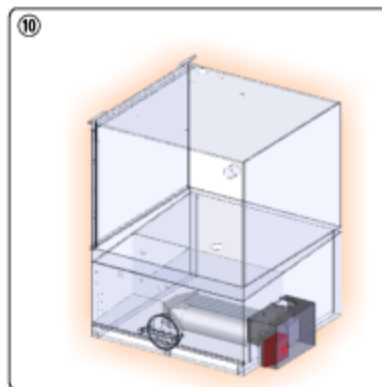
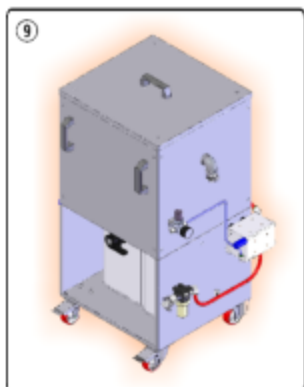
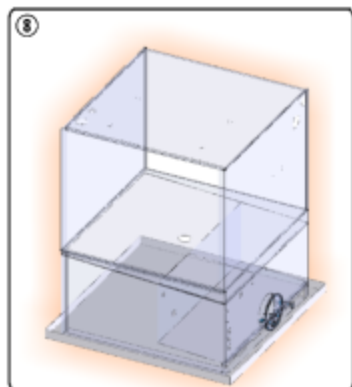
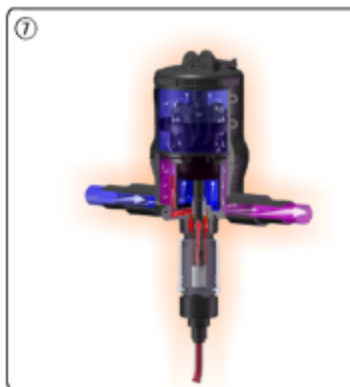
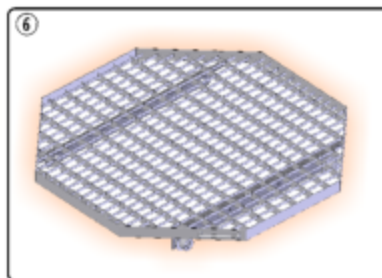
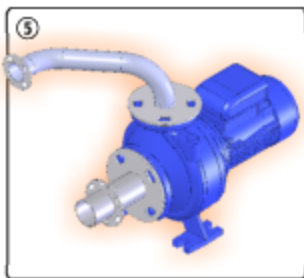
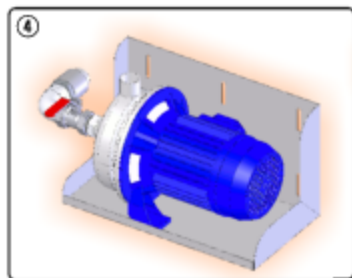
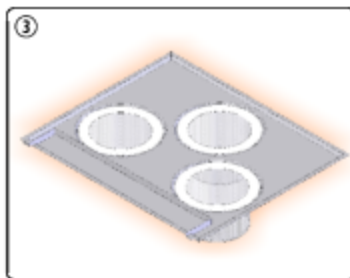
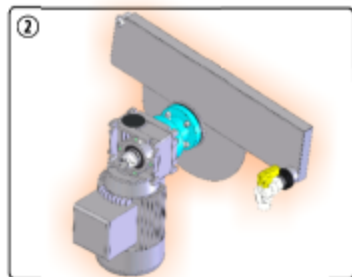
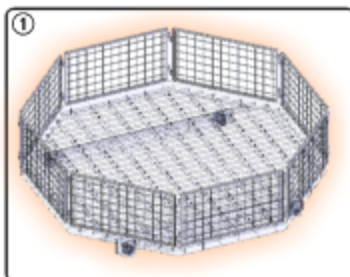
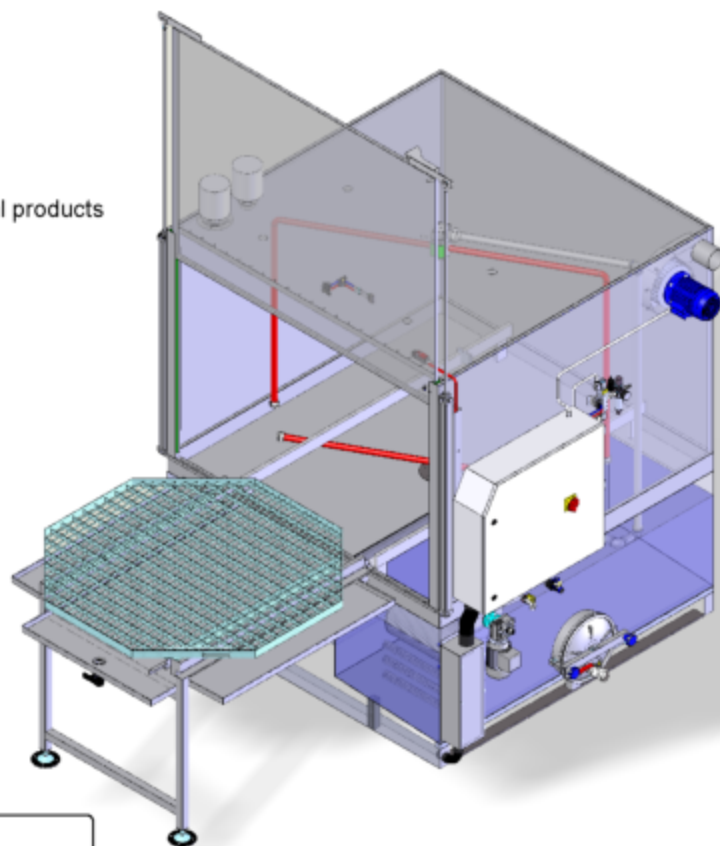

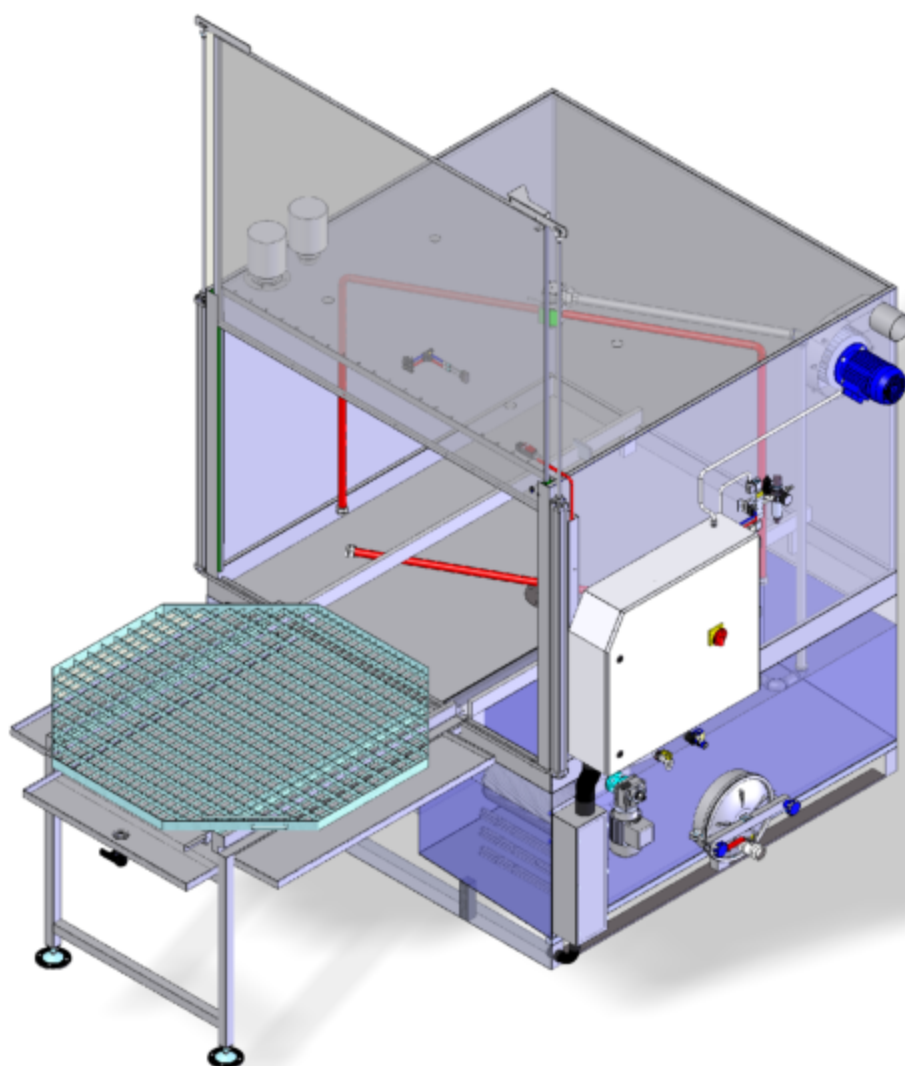

Technical table	ATOM				
	1000	1200	1400	1800	2200
Closed machine overall dim. (WxDxH) cm	165 x 240 x 200	185 x 280 x 210	205 x 310 x 220	240 x 390 x 235	285 x 470 x 240
Open machine overall dim. (WxDxH) cm	165 x 240 x 275	185 x 280 x 295	205 x 310 x 315	240 x 390 x 340	285 x 470 x 350
Washing capacity (Ø x H)	90 x 70 cm	110 x 80 cm	128 x 90 cm	165 x 100 cm	200 x 100
Basket load capacity	600 kg	600 kg	600 kg	600 kg	600 kg
Washing tank capacity	280 lt	350 lt	500 lt	700 lt	1000 lt
Washing pump	3,0 kw 2,5 bar 300 lt/min	3,0 kw 2,5 bar 350 lt/min	3,0 kw 2,5 bar 400 lt/min	3,0 kw 2,5 bar 450 lt/min	3,0 kw 2,5 bar 500 lt/min
Hight pressure washing pump	5,5 kw 5 bar 300 lt/min	5,5 kw 4,5 bar 350 lt/min	5,5 kw 4,5 bar 400 lt/min	7,5 kw 4,5 bar 450 lt/min	7,5 kw 4,5 bar 500 lt/min
Washing heating	10,0 kw	12,0 kw	18,0 kw	30,0 kw	40,0 kw
Vapour extractor	0,25 kw 320 m³/h	0,25 kw 320 m³/h	0,37 kw 580 m³/h	0,37 kw 580 m³/h	0,37 kw 580 m³/h
Disc oil separator	0,09 kw	0,09 kw	0,09 kw	0,09 kw	0,09 kw
Diesel or natural gas burner heating	0,17 kw	0,17 kw	0,17 kw	0,17 kw	0,17 kw
Tank emptying pump	0,37 kw	0,37 kw	0,37 kw	0,37 kw	0,37 kw
Electrical supply	3PH+N+T	3PH+N+T	3PH+N+T	3PH+N+T	3PH+N+T

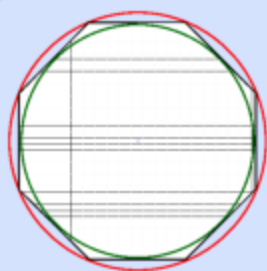

Model size	Useful	Maximum
1000	Ø 90 cm	Ø 100 cm
1200	Ø 110 cm	Ø 120 cm
1400	Ø 128 cm	Ø 140 cm
1800	Ø 165 cm	Ø 180 cm
2200	Ø 200 cm	Ø 220 cm

Connections	1000, 1200	1400, 1800, 2200
Vapour extraction outlet	Ø 80 mm	Ø 100 mm
Drain washing/rinsing tank(s)	F 1" 1/4 GAS	F 1" 1/4 GAS
Water filling electrovalve	F 3/4" GAS	F 3/4" GAS
Drain disk oil separator	M 1/2" GAS	M 1/2" GAS
Compr. air actuators electrov.	F 1/4" GAS	F 1/4" GAS
Tank emptying pump	F 1" GAS	F 1" GAS
Gas burner chimney	Ø 130 mm	Ø 130 mm

Table of dimensions

	ATOM				
	1000	1200	1400	1800	2200
L (width)	165 cm	185 cm	205 cm	240 cm	285 cm
P (depth)	240 cm	280 cm	310 cm	390 cm	470 cm
H (height)	275 cm	295 cm	315 cm	340 cm	350 cm
DL (washing diameter)	90 cm	110 cm	128 cm	165 cm	200 cm
HL (washing height)	70 cm	80 cm	90 cm	100 cm	100 cm
AC (load height)	95 cm	95 cm	95 cm	95 cm	95 cm
PV (chamber depth)	135 cm	155 cm	175 cm	210 cm	255 cm
HV (chamber height)	200 cm	210 cm	220 cm	235 cm	240 cm

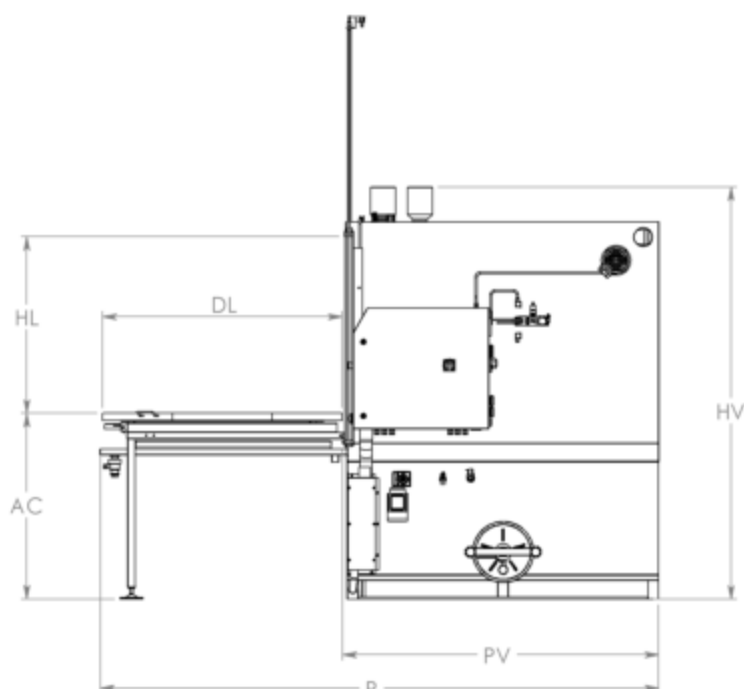
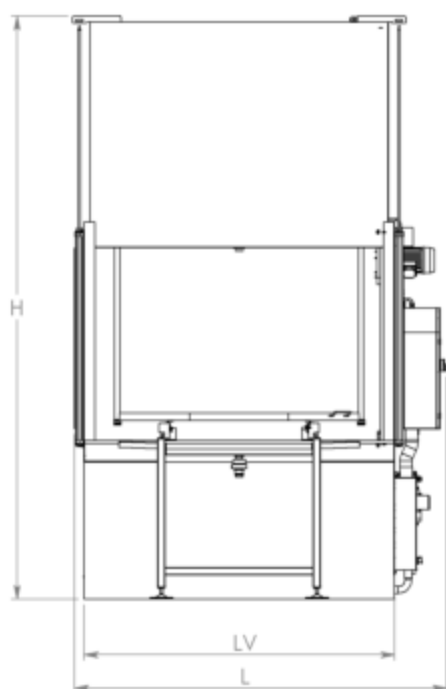

Simplex 60/80

Simplex is a system that washes small and medium sized mechanical parts automatically. Washing is carried out by means of the upper, lower and side jets, the basket slow rotation is ensured by a gearmotor.

The PLC allows you to manage time, temperatures, levels, signals and alarms. The easy to use and intuitive software is available in many languages.

Models

- Simplex 60, wash. cap. of Ø58 x H38 cm x 100kg
- Simplex 80, wash. cap. of Ø78 x H43 cm x 100kg

Versions

- electric LT, max. washing temperature: 60°C
- electric HT, maximum washing temperature: 80°C

Supply voltage

- 400V 3PH+N+T 50HZ (others on request)



STANDARD EQUIPMENT

- **Reinforced basket** of electrowelded net with external edge of galvanised iron (Simplex 80) or stainless steel Aisi 304 (Simplex 60)
- **Electric pump of stainless steel Aisi 304 with special gaskets**
- **Filter of stainless steel Aisi 304 on pump suction**
- **Tub edge gasket of EPDM**
- Electrical resistor of Incoloy stainless steel
- Mechanical basket rotation by gearmotor
- **Electrical cabinet IP65, PLC electrical system (DGT V4)**
- Structures and sheets of stainless steel
- **Flexible suction and delivery pump pipes (easy maintenance)**
- Safety limit switch on cover opening
- Laser-drilled washing piping of stainless steel (more pressure, less maintenance)
- Minimum level control of liquid inside the tank to protect pump and resistor
- **Maximum level control of liquid inside the tank and solenoid valve for automatic water filling**
- **Weekly programming for the activation of heating and oil separator (if installed)**

SPECIFIC EQUIPMENT FOR HT VERSION

- Electrical vapour extraction
- **Thermal insulation with panels of stainless steel Aisi 430**
- Safety limit switch with cover opening lock during the cycle
- **Panels under the basket with grease and chips collecting filters**

Technical table	S 60	S 80
Closed machine overall dimensions (W x D x H)	92 x 78 x 100 cm	112 x 100 x 110 cm
Opened machine overall dimensions (W x D x H)	92 x 86 x 153 cm	112 x 105 x 185 cm
Washing capacity (Ø x H)	58 x 38 cm	78 x 43 cm
Basket load capacity	100 kg	100 kg
Tank capacity	60 litre	130 litre
Washing pump	0,55 kw 2,0 bar 80 litre/min	0,55 kw 2,0 bar 80 litre/min
High pressure washing pump	2,2 kw 6,0 bar 120 lt/min	2,2 kw 5,0 bar 200 lt/min
Washing heating	4,0 kw	4,0 kw
Mechanical rotation	0,09 kw	0,09 kw
Vapour extractor	0,09 kw 70 m³/h	0,09 kw 70 m³/h
Blowing (air consumption at 6 bar)	150 m³/h	170 m³/h
Electrical supply	3PH+N+T	3PH+N+T

AVAILABLE ACCESSORIES

- ① High pressure pump
- ② Basket of Stainless steel Aisi 304
- ③ Vapour extraction (included for HT model)
- ④ Integrated disc oil separator
- ⑤ Detergent dosage system
- ⑥ Panels under the basket with grease collecting filters (included for model HT)
- ⑦ Blowing with compressed air and independent pipes *①
- ⑧ Preparation for the use of abrasive contaminants
- ⑨ Preparation for the use of strongly caustic chemical products
- ⑩ Bleaching of internal welding
- ⑪ Teflon and Viton gaskets *②

*① suction and panels under the basket are necessary
 *② excluding tank edge gasket and o-rings

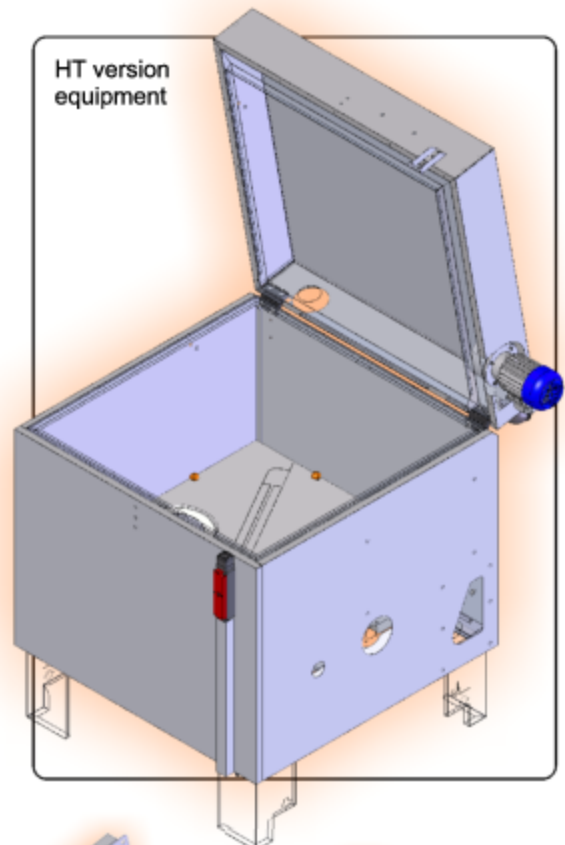
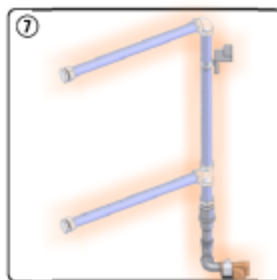
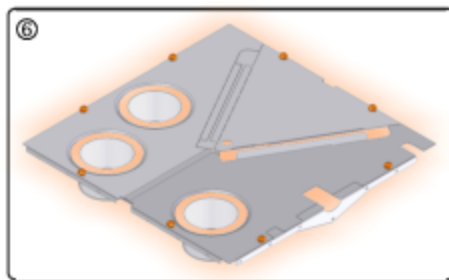
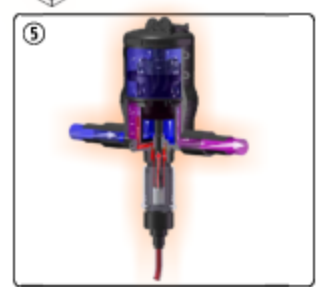
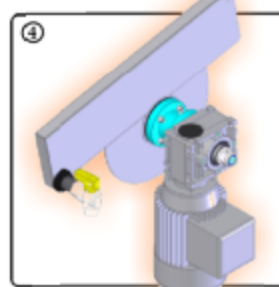
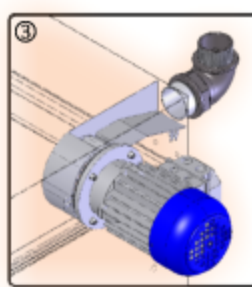
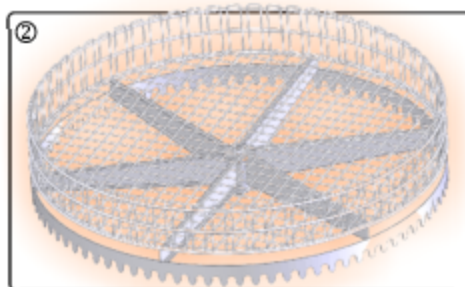
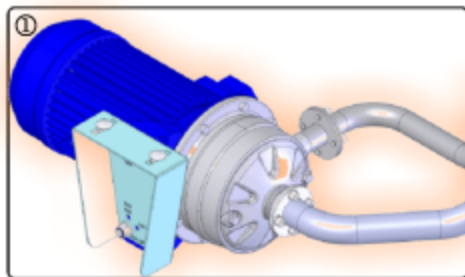

Connections	S 60 / S 80
Vapour extraction outlet	Ø 48 mm
Drain washing tank	F 1" GAS
Water filling electrovalve	F 3/4" GAS
Drain disk oil separator	M 1/2" GAS
Compress. air blowing electrov.	F 3/4" GAS

Table of dimensions	S 60	S 80
L (width)	92 cm	112 cm
P (depth)	86 cm	105 cm
H (height)	153 cm	185 cm
DL (washing diameter)	58 cm	78 cm
HL (washing height)	38 cm	43 cm
AC (load height)	83 cm	92 cm
LV (tank width)	64 cm	84 cm
PV (tank depth)	64 cm	84 cm
HA (opening angle)	80°	80°

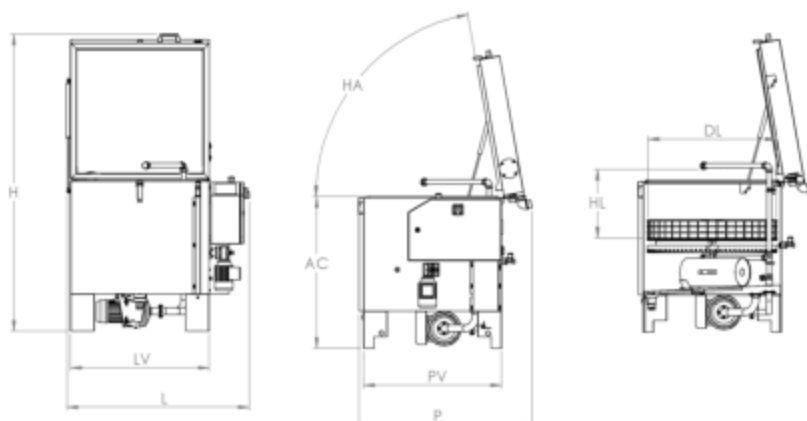

Simplex 100/120

Simplex is a system that washes automatically small and medium sized mechanical parts.

Washing is carried out by means of the upper, lower and side jets, the basket slow rotation is ensured via a gearmotor.

The easy to use and intuitive software can display informations in many languages.

Models

- Simplex 100, wash. cap. of Ø97 x H54 cm x 200kg
- Simplex 120, wash. cap. of Ø117 x H70 cm x 300kg

Versions

- electric LT, maximum washing temperature: 60°C
- electric HT, maximum washing temperature: 80°C

Supply voltage

- 400V 3PH+N+T 50HZ (others on request)



STANDARD EQUIPMENT

- **Timed vapour extraction**
- **Reinforced basket** of electrowelded net with external edge of galvanised iron
- **Electric pump of stainless steel Aisi 304 with special gaskets**
- **Filter of stainless steel Aisi 304 on pump suction**
- **Tub edge gasket of EPDM**
- Electrical resistor of Incoloy stainless steel
- Mechanical basket rotation via gearmotor
- **Electrical cabinet IP65, PLC electrical system (DGT V3)**
- Structure and sheets of stainless steel
- Flexible suction and delivery pump pipes (easy maintenance)
- Safety limit switch on cover opening
- **Laser-drilled washing piping of stainless steel (more pressure, less maintenance)**
- Minimum level control of liquid inside the tank to protect pump and resistor
- Maximum level control of liquid inside the tank and solenoid valve for automatic water loading
- **Weekly programming for the activation of heating and oil separator (if installed)**

SPECIFIC EQUIPMENT FOR HT VERSION

- **Thermal insulation with panels of Stainless steel Aisi 430**
- Safety limit switch with cover opening lock during the cycle
- **Panels under the basket with grease and chips collecting filters**

Connections	S 100	S 120
Vapour extraction outlet	Ø 80 mm	Ø 80 mm
Drain washing tank	F 1" GAS	F 1" GAS
Water filling electrovalve	F 3/4" GAS	F 3/4" GAS
Drain disk oil separator	M 1/2" GAS	M 1/2" GAS
Compressed air blowing electrov.	F 3/4" GAS	F 3/4" GAS

Technical table	S 100	S 120
Closed machine overall dimensions (W x D x H)	146 x 144 x 125 cm	166 x 159 x 145 cm
Opened machine overall dimensions (W x D x H)	146 x 175 x 191 cm	166 x 206 x 211 cm
Washing capacity (Ø x H)	97 x 54 cm	117 x 70 cm
Basket load capacity	200 kg	300 kg
Washing tank capacity	210 litre	270 litre
Washing pump	1,5 kw 2,5 bar 200 litre/min	1,5 kw 2,5 bar 200 litre/min
High pressure washing pump	4,0 kw 6,0 bar 350 lt/min	4,0 kw 6,0 bar 350 lt/min
Washing heating	6,0 kw	8,0 kw
Mechanical rotation	0,09 kw	0,09 kw
Vapour extractor	0,25 kw 320 m³/h	0,25 kw 320 m³/h
Disc oil separator	0,09 kw	0,09 kw
Vapour condenser	0,28 kw	0,28 kw
Tank emptying pump	0,37 kw	0,37 kw
Drying	4,5 kw	4,5 kw
Blowing (air consump. at 6 bar)	300 m³/h	300 Nm³/h
Electrical supply	3PH+N+T	3PH+N+T

AVAILABLE ACCESSORIES

- ① Detergent dosage system
- ② External pneumatic oil separator
- ③ Manual washing and blowing with hoses and internal washing nozzle
- ④ External trolley of stainless steel Aisi 304 *①
- ⑤ System retention tank of stainless steel Aisi 304
- ⑥ Pneumatic opening and closing of the cover with two-hand safety control
- ⑦ Panels under the basket with grease and chips collecting filters (included in HT)
- ⑧ Blowing with compressed air and independent pipes *②
- ⑨ High pressure pump
- ⑩ Disc oil separator with dedicated gearmotor
- ⑪ Bag filter placed on the pump delivery *③
- ⑫ Drying with resistor and blower with air-blade side channels
- ⑬ Reinforced basket of stainless steel Aisi 304
- ⑭ Tank emptying pump
- ⑮ Electric vapour condenser (reduction by 80% at 80° C)
- ⑯ Teflon and Viton gaskets *④
- ⑰ Preparation for the use of abrasive contaminants in the washing fluid
- ⑱ Preparation for the use of strongly caustic chemical products
- ⑲ Thermal insulation of the bag filter
- ⑳ Bleaching of internal welding

*① useful washing height reduced by mm. 120, basket of stainless steel is mandatory.

*② extraction and panels under the basket are necessary

*③ filter insulation is mandatory for HT machines

*④ excluding tank edge gasket and o-rings

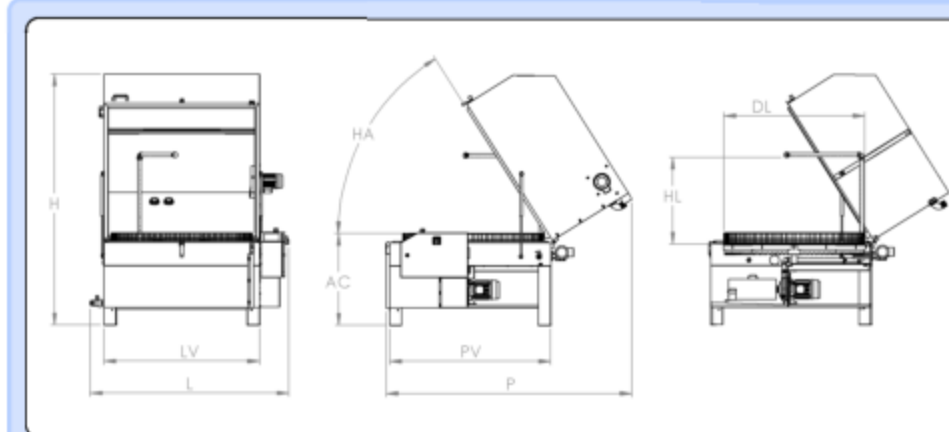
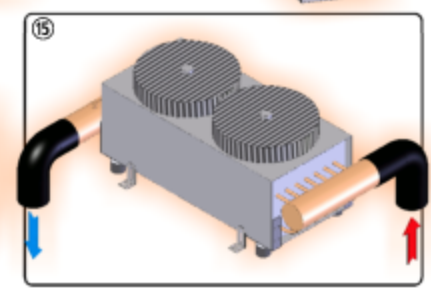
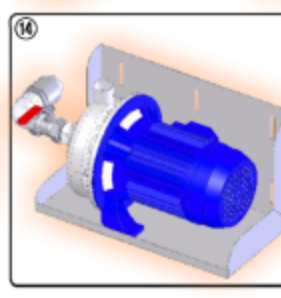
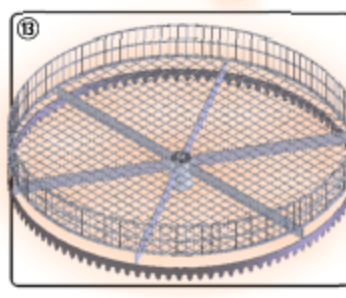
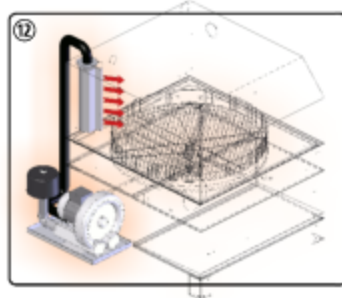
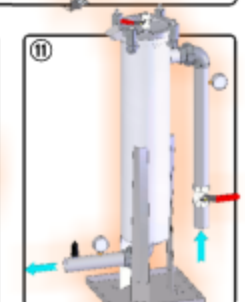
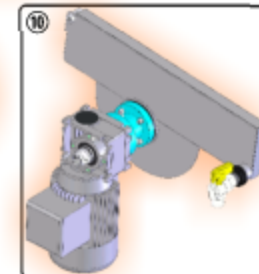
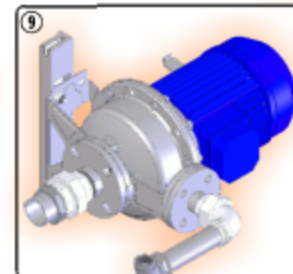
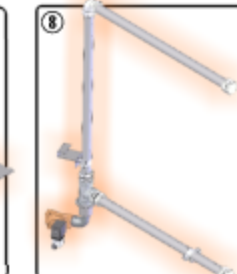
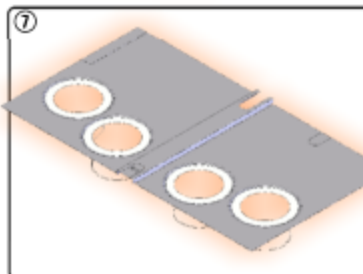
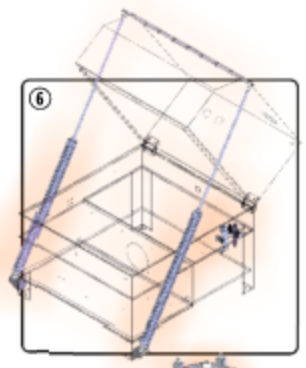
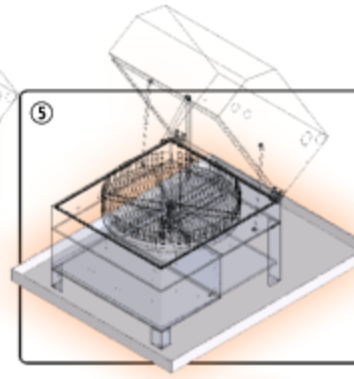
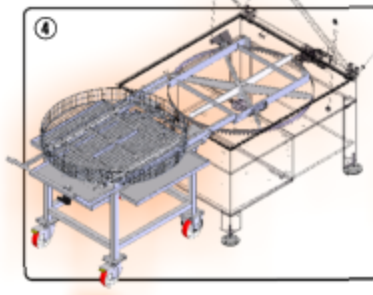
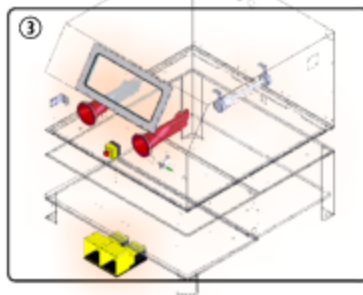
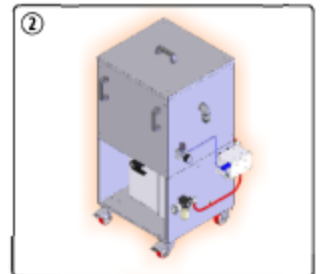
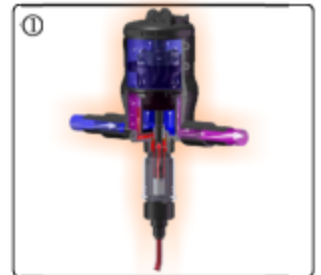

Table of dimensions	S 100	S 120
L (width)	146 cm	166 cm
P (depth)	175 cm	206 cm
H (height)	191 cm	211 cm
DL (washing diameter)	97 cm	117 cm
HL (washing height)	54 cm	70 cm
AC (load height)	67 cm	67 cm
LV (tank width)	110 cm	130 cm
PV (tank depth)	120 cm	135 cm
HA (opening angle)	60°	60°

Simplex Big 1B

Simplex Big is a system that washes automatically medium and large mechanical parts. Washing is carried out by means of the upper, lower and side jets, the platform slow rotation is ensured by a gearmotor with torque limiter. The PLC allows you to manage time, temperatures, levels, signals and alarms. The easy to use and intuitive software can display informations in many languages.

Models

- Simplex Big 1000, w.c. Ø90 x H70 cm x 600kg
- Simplex Big 1200, w.c. Ø110 x H80 cm x 600kg
- Simplex Big 1400, w.c. Ø128 x H90 cm x 600kg
- Simplex Big 1800, w.c. Ø165 x H100 cm x 800kg
- Simplex Big 2200, w.c. Ø200 x H100 cm x 800kg

Versions

- electric LT, max. washing temperature 60°C
- electric HT, max. washing temperature 80°C

Supply voltage

- 400V 3PH+N+T 50HZ (others on request)



1B

PLC TOUCH

STANDARD EQUIPMENT

- **Timed vapour extraction**
- **Two-hand control for door closing with safety control unit**
- External loading/unloading trolley with drip collector of stainless steel Aisi 304 and wheels with safety brake
- ISO pneumatic cylinders and «anti-fall» pneumatic safety valves
- **Electric pump of stainless steel with special gaskets**
- Filter of stainless steel Aisi 304 on pump suction
- Minimum level control of the liquid inside the tank to protect pump and resistor
- Maximum level control of the liquid inside the tank and solenoid valve for automatic water loading
- **Gearmotor for platform rotation with torque limiter and centring sensor**
- Electrical resistors of Incoloy stainless steel
- Safety limit switch on door opening
- **Electrical cabinet IP65, PLC electrical system (DGT V4)**
- Structure and sheets of stainless steel
- Lower load-bearing structure of galvanized iron
- Triple door gasket (lower, upper and lateral)
- Reinforced platform of pressed grating with raised external edge, of galvanized iron
- **Upper, lateral and lower fixed washing pipes, laser-drilled made of stainless steel Aisi 304**
- Sludge discharging door for an easy tank cleaning

SPECIFIC EQUIPMENT FOR HT VERSION

- Overall thermal insulation with panels of stainless steel Aisi 430

AVAILABLE ACCESSORIES

- ① High pressure washing pump
- ② Additional external trolley
- ③ Platform borders, removable, H20 cm, of stainless steel Aisi 304
- ④ Disc oil separator with gearmotor
- ⑤ Platform and spider of stainless steel INOX Aisi 304
- ⑥ Panels under the platform with grease collecting filters *①
- ⑦ Emptying pump
- ⑧ Detergent dosage system
- ⑨ Electric vapour condenser (reduction by 80% at 80° C)
- ⑩ Bag filter placed on the pump delivery *②
- ⑪ System retention tank of stainless steel Aisi 304
- ⑫ Liquid heating by diesel or natural gas burner *③
- ⑬ Loading and unloading station *④
- ⑭ Loading/unloading fixed position (instead of the trolley)
- ⑮ External pneumatic oil separator
- ⑯ Drying with resistor and blower *⑤
- ⑰ Manual washing and blowing with hoses
- ⑱ Blowing with compressed air, pipes of stainless steel Aisi 304
- ⑲ Increased height of the washing chamber
- ⑳ Thermal insulation of the bag filter
- ㉑ Predisposition for the use with abrasive contaminants
- ㉒ Predisposition for the use with strongly caustic chemical products
- ㉓ Bleaching of internal welding

- *③ filter insulation is mandatory for HT machines
 *④ washing height is reduced by 130 mm
 *⑤ panels under the basket are necessary

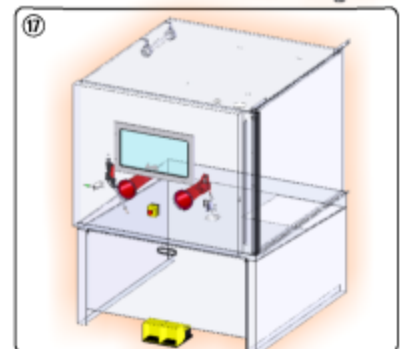
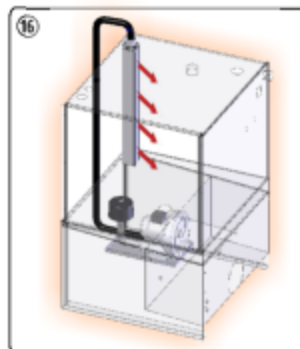
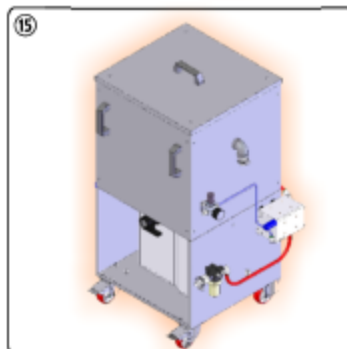
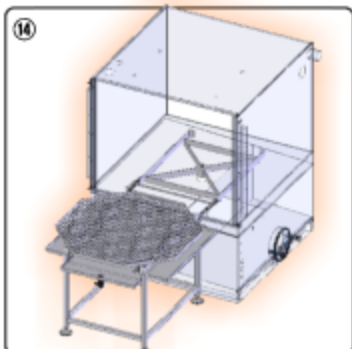
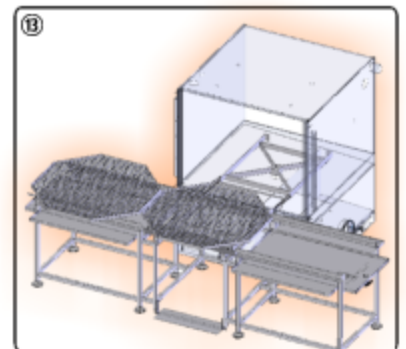
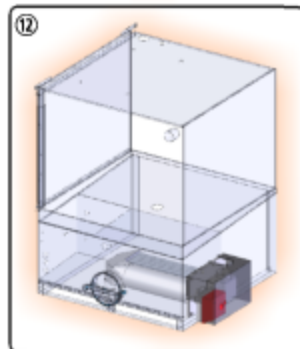
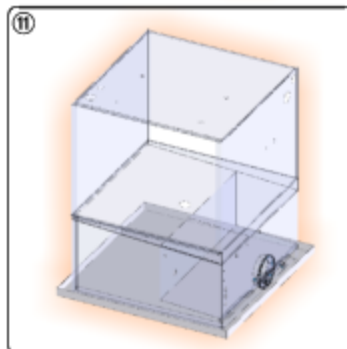
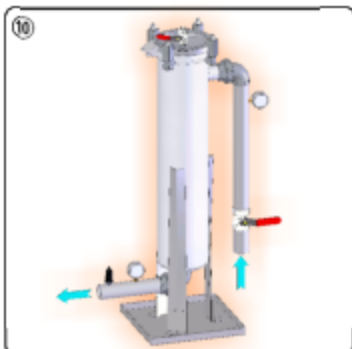
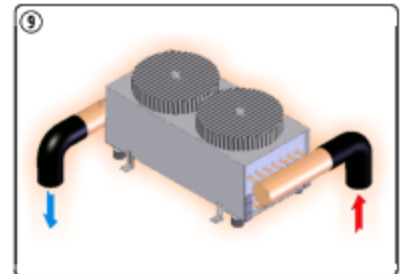
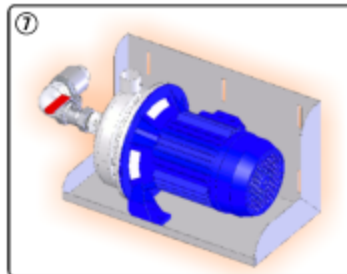
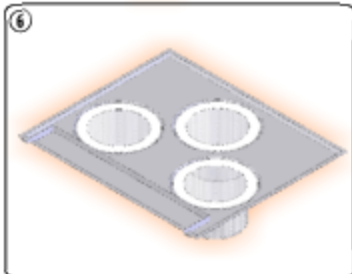
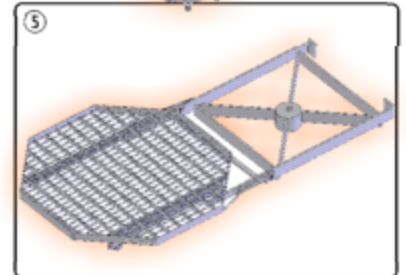
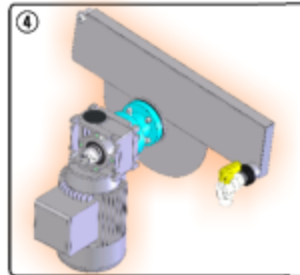
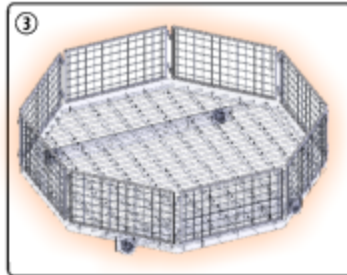
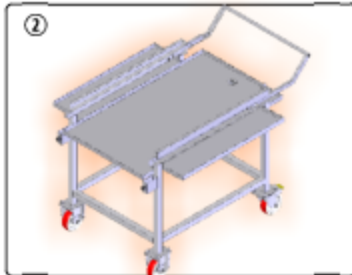
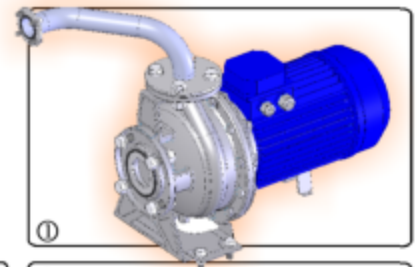

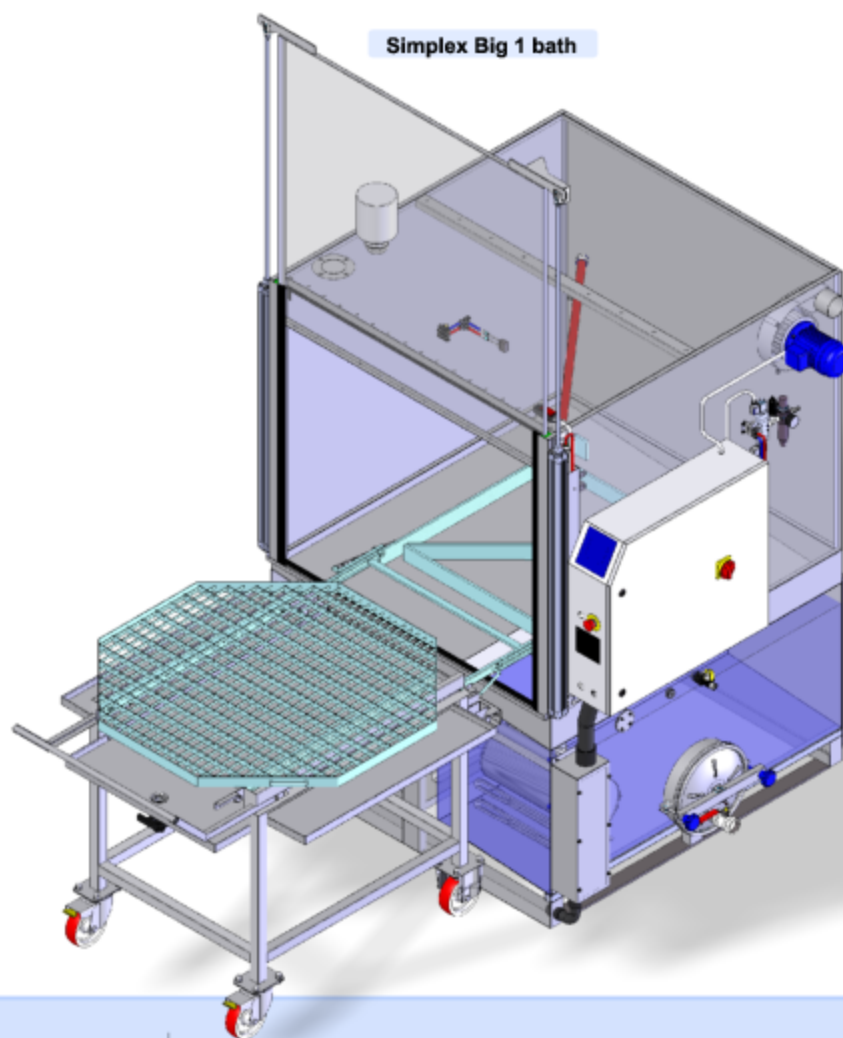

Simplex Big 1 bath

Tabella tecnica	Simplex Big 1 bath				
	1000	1200	1400	1800	2200
Closed machine overall dim. (WxDxH) cm	165 x 260 x 200	185 x 300 x 210	205 x 330 x 220	240 x 395 x 235	285 x 480 x 240
Open machine overall dim. (WxDxH) cm	165 x 260 x 275	185 x 300 x 315	205 x 330 x 315	240 x 395 x 340	285 x 480 x 345
Washing capacity (Ø x H)	90 x 70	110 x 80	128 x 90	165 x 100	200 x 100
Platform load capacity	600 kg	600 kg	600 kg	800 kg	800 kg
Washing tank capacity	280 lt	350 lt	500 lt	700 lt	1000 lt
Washing pump	3,0 kw 2,5 bar 300 lt/min	3,0 kw 2,5 bar 350 lt/min	3,0 kw 2,5 bar 400 lt/min	3,0 kw 2,5 bar 450 lt/min	3,0 kw 2,5 bar 500 lt/min
Hight pressure washing pump	5,5 kw 5 bar 300 lt/min	5,5 kw 4,5 bar 350 lt/min	5,5 kw 4,5 bar 400 lt/min	7,5 kw 4,5 bar 450 lt/min	7,5 kw 4,5 bar 500 lt/min
Washing heating	10,0 kw	12,0 kw	18,0 kw	30,0 kw	40,0 kw
Mechanical rotation	0,18 kw	0,18 kw	0,18 kw	0,18 kw	0,18 kw
Vapour extractor	0,25 kw 320 m³/h	0,25 kw 320 m³/h	0,37 kw 580 m³/h	0,37 kw 580 m³/h	0,37 kw 580 m³/h
Disc oil separator	0,09 kw	0,09 kw	0,09 kw	0,09 kw	0,09 kw
Blowing (air consumption at 6 bar)	300 m³/h	350 m³/h	450 m³/h	600 m³/h	750 m³/h
Diesel or natural gas burner heating	0,17 kw	0,17 kw	0,17 kw	0,17 kw	0,17 kw
Vapour condenser	0,28 kw	0,28 kw	0,58 kw	0,58 kw	0,58 kw
Tank emptying pump	0,37 kw	0,37 kw	0,37 kw	0,37 kw	0,37 kw
Drying with resistor and blower	5,2 kw	5,2 kw	5,2 kw	8,2 kw	8,2 kw
Electrical supply	3PH+N+T	3PH+N+T	3PH+N+T	3PH+N+T	3PH+N+T

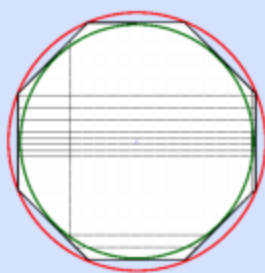

Model size	Useful	Maximum
1000	Ø 90 cm	Ø 100 cm
1200	Ø 110 cm	Ø 120 cm
1400	Ø 128 cm	Ø 140 cm
1800	Ø 165 cm	Ø 180 cm
2200	Ø 200 cm	Ø 220 cm

Connections	1000, 1200	1400, 1800, 2200
Vapour extraction outlet	Ø 80 mm	Ø 100 mm
Drain washing tank	F 1" 1/4 GAS	F 1" 1/4 GAS
Water filling electrovalve	F 3/4" GAS	F 3/4" GAS
Drain disk oil separator	M 1/2" GAS	M 1/2" GAS
Compr. air actuators electrov.	F 1/4" GAS	F 1/4" GAS
Compr. air blowing electrov.	F 1" GAS	F 1" GAS
Tank emptying pump	F 1" GAS	F 1" GAS
Gas burner chimney	Ø 130 mm	Ø 130 mm

Table of dimensions

SIMPLEX BIG 1 bath

	1000	1200	1400	1800	2200
L (width)	165 cm	195 cm	205 cm	240 cm	285 cm
P (depth)	260 cm	300 cm	330 cm	395 cm	480 cm
H (height)	275 cm	295 cm	315 cm	340 cm	345 cm
DL (washing diameter)	90 cm	110 cm	128 cm	165 cm	200 cm
HL (washing height)	70 cm	80 cm	90 cm	100 cm	100 cm
AC (load height)	95 cm	95 cm	95 cm	95 cm	95 cm
PV (chamber depth)	135 cm	155 cm	175 cm	210 cm	255 cm
HV (chamber height)	200 cm	210 cm	220 cm	235 cm	240 cm

Simplex Big 1 bath

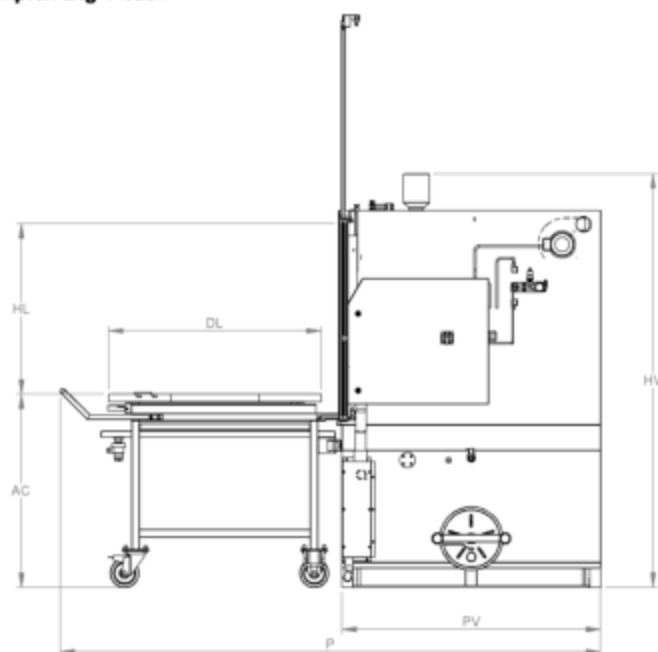
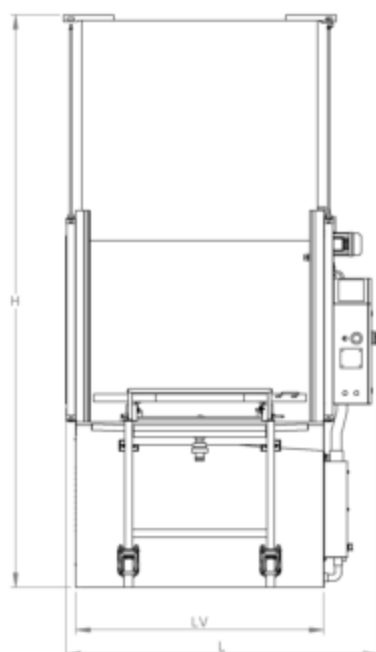

Simplex Big 2B

Simplex Big is a system that washes automatically medium and large mechanical parts. Washing is carried out by means of the upper, lower and side jets, the platform slow rotation is ensured by a gearmotor with torque limiter. In the two-bath version, the system washes and rinses the treated parts. The PLC allows you to manage time, temperatures, levels, signals and alarms. The easy to use and intuitive software can display informations in many languages.

Models

- Simplex Big 1000, w.c. Ø90 x H70 cm x 600kg
- Simplex Big 1200, w.c. Ø110 x H80 cm x 600kg
- Simplex Big 1400, w.c. Ø128 x H90 cm x 600kg
- Simplex Big 1800, w.c. Ø165 x H100 cm x 800kg
- Simplex Big 2200, w.c. Ø200 x H100 cm x 800kg

Versions

- electric LT, max. washing temperature 60°C
- electric HT, max. washing temperature 80°C

Supply voltage

- 400V 3PH+N+T 50HZ (others on request)



2B



STANDARD EQUIPMENT

- **Timed vapour extraction**
- **Two-hand control for door closing with safety control unit**
- External loading/unloading trolley with drip collector of stainless steel Aisi 304 and wheels with safety brake
- ISO pneumatic cylinders and «anti-fall» pneumatic safety valves
- **Electric pumps of stainless steel with special gaskets**
- Filters of stainless steel Aisi 304 on pumps suction
- Minimum level control of the liquids inside the tanks to protect pumps and resistors
- Maximum level control of the liquids inside the tanks and solenoid valves for automatic water loading
- **Gearmotor for platform rotation with torque limiter and centring sensor**
- Electrical resistors of Incoloy stainless steel
- Safety limit switch on door opening
- **Electrical cabinet IP65, PLC electrical system (DGT V4)**
- Structure and sheets of stainless steel
- Lower load-bearing structure of galvanized iron
- Triple door gasket (lower, upper and lateral)
- Reinforced platform of pressed grating with raised external edge, of galvanised iron
- **Upper, lateral and lower fixed washing (rinsing, blowing) pipes, laser-drilled made of stainless steel Aisi 304**
- Sludge discharging doors for an easy tank cleaning

SPECIFIC EQUIPMENT FOR HT VERSION

- Overall thermal insulation with panels of stainless steel Aisi 430

AVAILABLE ACCESSORIES

- ① Platform borders, removable, H20 cm, of stainless steel Aisi 304
- ② Disc oil separator with gearmotor
- ③ Platform and spider of stainless steel INOX Aisi 304
- ④ High pressure washing pump
- ⑤ Emptying pump
- ⑥ Detergent dosage system
- ⑦ Electric vapour condenser (reduction by 80% at 80° C)
- ⑧ Additional external trolley
- ⑨ Bag filter placed on the pump delivery *⑥
- ⑩ System retention tank of stainless steel Aisi 304
- ⑪ Loading and unloading station *④
- ⑫ Loading/unloading fixed position (instead of the trolley)
- ⑬ External pneumatic oil separator
- ⑭ Drying with resistor and blower
- ⑮ Manual washing and blowing with hoses
- Blowing with compressed air, pipes of stainless steel Aisi 304
- Increased height of the washing chamber
- Thermal insulation of the bag filter
- Predisposition for the use with abrasive contaminants
- Predisposition for the use with strongly caustic chemical products
- Bleaching of internal welding

*④ washing height is reduced by 130 mm
 *⑥ panels under the basket are necessary

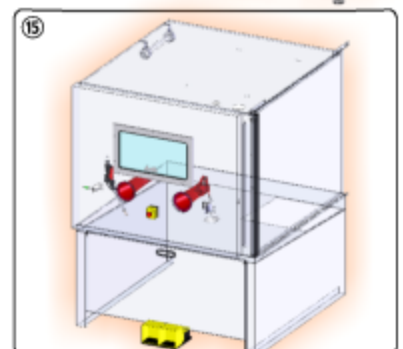
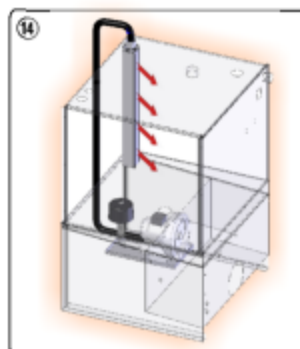
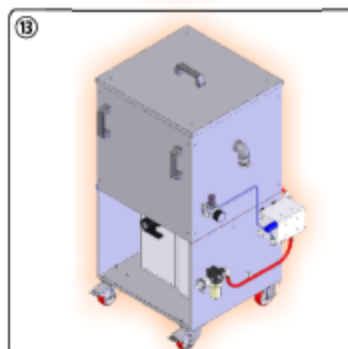
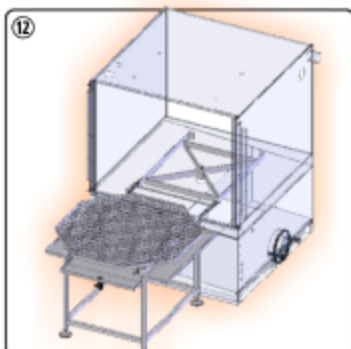
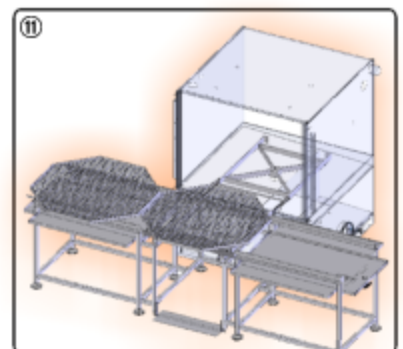
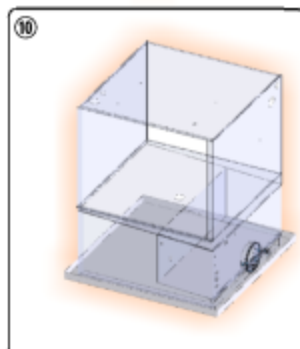
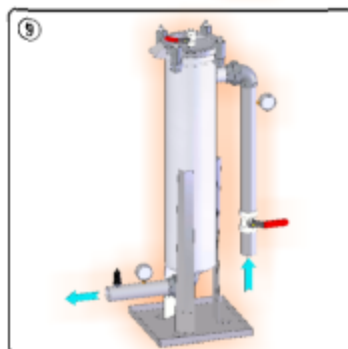
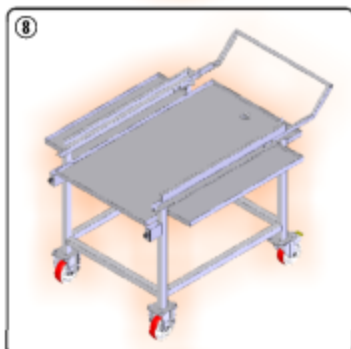
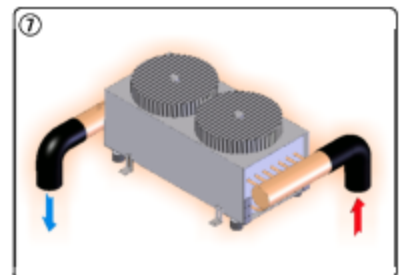
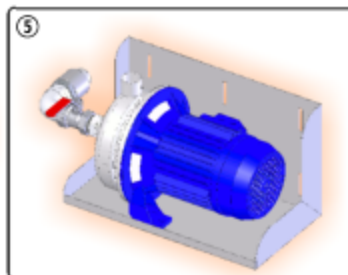
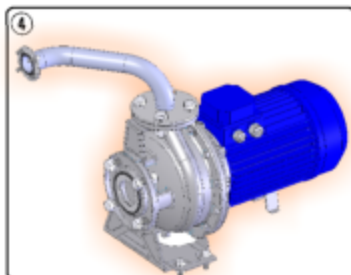
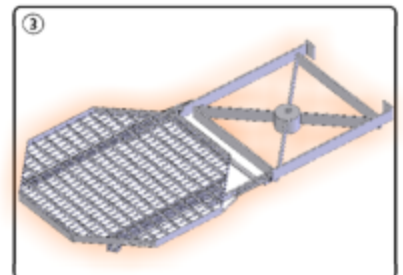
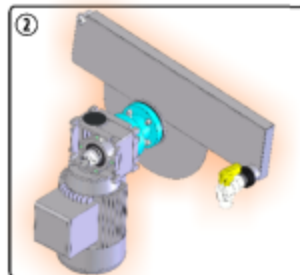
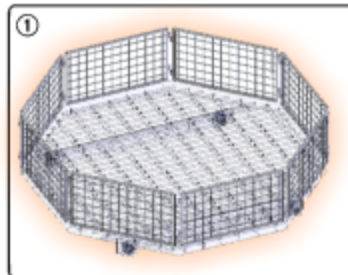

Simplex Big 2 baths

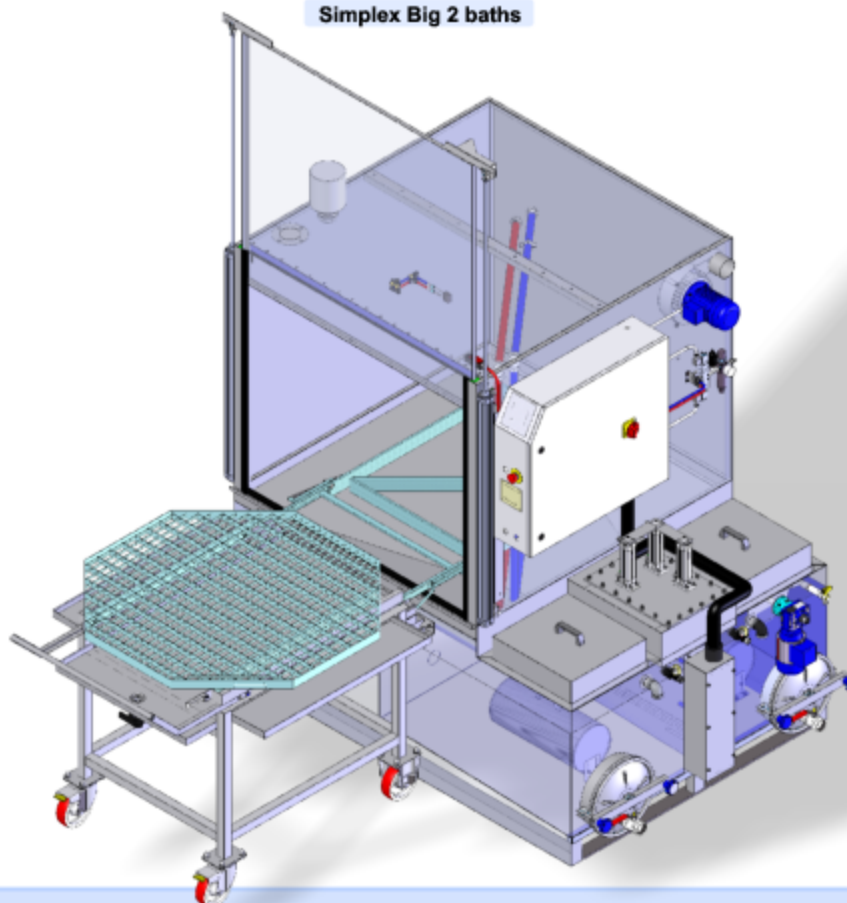

Technical table	Simplex Big 2 baths				
	1000	1200	1400	1800	2200
Closed machine overall dim. (WxDxH) cm	205 x 260 x 200	230 x 300 x 210	250 x 330 x 220	280 x 400 x 235	330 x 480 x 240
Open machine overall dim. (WxDxH) cm	205 x 260 x 275	230 x 300 x 295	250 x 330 x 315	280 x 400 x 340	330 x 480 x 345
Washing capacity (Ø x H)	90 x 70	110 x 80	128 x 90	165 x 100	200 x 100
Platform load capacity	600 kg	600 kg	600 kg	800 kg	800 kg
Washing/rinsing tanks capacity	250 lt / 250 lt	300 lt / 300 lt	400 lt / 400 lt	550 lt / 550 lt	750 lt / 750 lt
Washing pump	3,0 kw 2,5 bar 300 lt/min	3,0 kw 2,5 bar 350 lt/min	3,0 kw 2,5 bar 400 lt/min	3,0 kw 2,5 bar 450 lt/min	3,0 kw 2,5 bar 500 lt/min
Hight pressure washing pump	5,5 kw 5 bar 300 lt/min	5,5 kw 4,5 bar 350 lt/min	5,5 kw 4,5 bar 400 lt/min	7,5 kw 4,5 bar 450 lt/min	7,5 kw 4,5 bar 500 lt/min
Rinsing pump	3,0 kw 2,5 bar 300 lt/min	3,0 kw 2,5 bar 350 lt/min	3,0 kw 2,5 bar 400 lt/min	3,0 kw 2,5 bar 450 lt/min	3,0 kw 2,5 bar 500 lt/min
Washing/rinsing heating	10,0 kw / 10,0 kw	12,0 kw / 12,0 kw	16,0 kw / 16,0 kw	20,0 kw / 20,0 kw	30,0 kw / 30,0 kw
Mechanical rotation	0,18 kw	0,18 kw	0,18 kw	0,18 kw	0,18 kw
Vapour extractor	0,25 kw 320 m³/h	0,25 kw 320 m³/h	0,37 kw 580 m³/h	0,37 kw 580 m³/h	0,37 kw 580 m³/h
Disc oil separator	0,09 kw	0,09 kw	0,09 kw	0,09 kw	0,09 kw
Blowing (air consumption at 6 bar)	300 m³/h	350 m³/h	450 m³/h	600 m³/h	750 m³/h
Diesel or natural gas burner heating	0,17 kw	0,17 kw	0,17 kw	0,17 kw	0,17 kw
Vapour condenser	0,28 kw	0,28 kw	0,58 kw	0,58 kw	0,58 kw
Tanks emptying pump	0,37 kw	0,37 kw	0,37 kw	0,37 kw	0,37 kw
Drying with resistor and blower	5,2 kw	5,2 kw	5,2 kw	8,2 kw	8,2 kw
Electrical supply	3PH+N+T	3PH+N+T	3PH+N+T	3PH+N+T	3PH+N+T

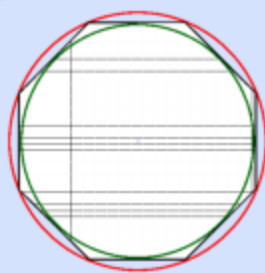

Model size	Useful	Maximum
1000	Ø 90 cm	Ø 100 cm
1200	Ø 110 cm	Ø 120 cm
1400	Ø 128 cm	Ø 140 cm
1800	Ø 165 cm	Ø 180 cm
2200	Ø 200 cm	Ø 220 cm

Connections	1000, 1200	1400, 1800, 2200
Vapour extraction outlet	Ø 80 mm	Ø 100 mm
Drain washing/rinsing tanks	F 1" 1/4 GAS	F 1" 1/4 GAS
Water filling electrovalve	F 3/4" GAS	F 3/4" GAS
Drain disk oil separator	M 1/2" GAS	M 1/2" GAS
Compr. air actuators electrov.	F 1/4" GAS	F 1/4" GAS
Compr. air blowing electrov.	F 1" GAS	F 1" GAS
Tanks emptying pump	F 1" GAS	F 1" GAS
Gas burner chimney	Ø 130 mm	Ø 130 mm
Drain overflow tanks	F 1" GAS	F 1" GAS

Table of dimensions	SIMPLEX BIG 2 baths				
	1000	1200	1400	1800	2200
L (width)	205 cm	230 cm	250 cm	280 cm	330 cm
P (depth)	260 cm	300 cm	330 cm	400 cm	480 cm
H (height)	275 cm	295 cm	315 cm	340 cm	345 cm
DL (washing diameter)	90 cm	110 cm	128 cm	165 cm	200 cm
HL (washing height)	70 cm	80 cm	90 cm	100 cm	100 cm
AC (load height)	95 cm	95 cm	95 cm	95 cm	95 cm
PV (chamber depth)	135 cm	155 cm	175 cm	210 cm	255 cm
HV (chamber height)	200 cm	210 cm	220 cm	235 cm	240 cm

Simplex Big 2 baths

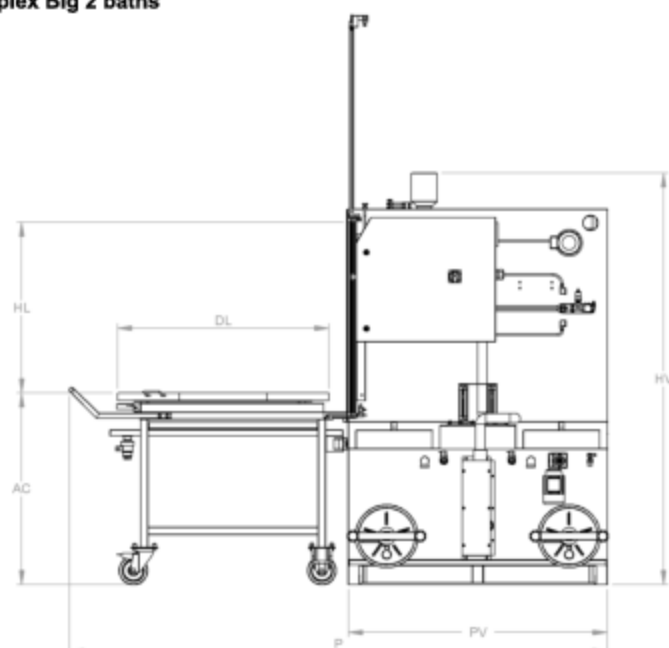
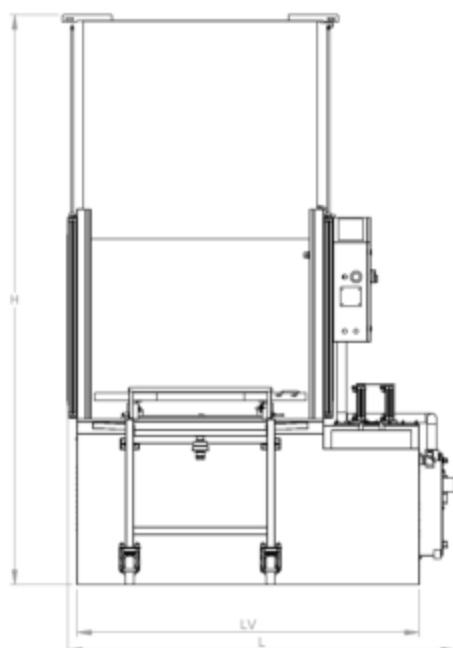

Comparison	P 60/80	SIMPLEX 60/80
Washing pump	Stainless steel	Stainless steel
Electric control board	Electromechanic	PLC + HMI Touch
Minimum level control of the liquid	●	●
Maximum level control of the liquid and automatic water filling	-	●
High pressure pump	-	○
Stainless steel basket	○	○
Vapour extraction system	-	○
Disc oil separator	○	○
Detergent dosage system	-	○
Panels under the basket with grease collecting filters	○	○
Blowing with compressed air	-	○
Preparation for the use of abrasive contaminants	-	○
Preparation for the use of strongly caustic chemical products	-	○
Bleaching of internal welding	-	○
Teflon and Viton gaskets	-	○
Others supply voltage	○	○



Comparison	P 100/120	SIMPLEX 100/120
Washing pump	Stainless steel	Stainless steel
Electric control board	Electromechanic	PLC + HMI Touch
Minimum level control of the liquid	●	●
Maximum level control of the liquid and automatic water filling	-	●
Stainless steel basket	○	○
Vapour extraction system	●	●
Disc oil separator	○	○
External pneumatic oil separator	-	○
Detergent dosage system	-	○
Panels under the basket with grease collecting filters	○	○
Manual washing and blowing with hoses	-	○
External trolley of stainless steel Aisi 304	-	○
System retention tank of stainless steel Aisi 304	-	○
Pneumatic opening and closing of the cover	-	○
Blowing with compressed air	-	○
High pressure pump	-	○
Bag filter placed on the pump delivery	-	○
Drying with resistor and blower with air-blade side channels	-	○
Tank emptying pump	-	○
Electric vapour condenser	-	○
Teflon and Viton gaskets	-	○
Preparation for the use of abrasive contaminants	-	○
Preparation for the use of strongly caustic chemical products	-	○
Thermal insulation of the bag filter	-	○
Bleaching of internal welding	-	○
Others supply voltage	○	○



Comparison	ATOM	SIMPLEX BIG
Pompa di lavaggio	Cast iron	Stainless steel
Electric control board	Electromechanic	PLC + HMI Touch
Fixed loading platform, free rotating jets	●	-
Rotating platform by gearmotor, fixed jets	-	●
Fixed loading/unloading area, of Stainless steel	●	○
Loading/unloading external trolley of Stainless steel	-	●
Minimum level control of the liquid	●	●
Maximum level control of the liquid and automatic water filling	●	●
Vapour extraction system	●	●
Disc oil separator	○	○
External pneumatic oil separator	-	○
Panels under the basket with grease collecting filters	○	○
High pressure washing pump	○	○
Platform borders, removable, H20 cm, of stainless steel	○	○
Platform and spider of stainless steel Aisi 304	○	○
Tank emptying pump	○	○
Detergent dosage system	○	○
Electric vapour condenser	-	○
Bag filter placed on the washing pump delivery	-	○
System retention tank of stainless steel Aisi 304	○	○
Heating by diesel or natural gas burner	○	○
External loading and unloading station	-	○
Drying with resistor and blower	-	○
Manual washing and blowing with hoses	-	○
Blowing with compressed air	-	○
Increased height of washing chamber	-	○
Thermal insulation of the bag filter	-	○
Preparation for the use of abrasive contaminants	○	○
Preparation for the use of strongly caustic chemical products	○	○
Bleaching of internal welding	○	○
Others supply voltage	○	○



Legend: ● included in standard version, ○ non included in standard version but available as accessory, - non available.

SME is a brand of:

TEKNOX SRL
Via Mori, 6 - 40054,
Prunaro di Budrio
(Bologna) - Italy

Tel: +39 051 800862
Fax: +39 051 803769

e-mail: info@smeclean.com
website: www.smeclean.com

This catalogue cancels and replaces any previous version and revision.
All listed data are approximate and without obligation on our behalf.
We reserve the right to implement modifications without notice.

